



# Northumberland County Council

## NORTH NORTHUMBERLAND LOCAL AREA COUNCIL RIGHTS OF WAY SUB-COMMITTEE

26 February 2020

---

### REVIEW OF THE DEFINITIVE MAP AND STATEMENT OF PUBLIC RIGHTS OF WAY

#### ALLEGED BYWAY OPEN TO ALL TRAFFIC No 11 PARISH OF CALLALY

Report of the Executive Director of Local Services  
Cabinet Member: Councillor Glen Sanderson, Environment and Local Services

---

#### **Purpose of report**

In this report, the North Northumberland Local Area Council Rights of Way Sub-Committee is asked to consider all the relevant evidence gathered in support and in rebuttal of the existence of public vehicular rights over a spur of the U4005 road, from the main U4005 road west of Lorbottle, north-westwards to Lorbottle Weststeads.

#### **Recommendation**

**It is recommended that the sub-committee agrees that:**

- (i) there is sufficient evidence to indicate that public vehicular rights have been reasonably alleged to exist over the route J-X;**
- (ii) the Natural Environment and Rural Communities Act 2006 would not appear to have extinguished the public's motorized vehicular rights over the J-X route;**
- (iii) there is not sufficient evidence to indicate that public vehicular rights have been reasonably alleged to exist over the route X-K;**
- (iv) there is sufficient evidence to indicate that public footpath rights have been reasonably alleged to exist over the route X-K;**
- (v) the J-X route be included in a future Definitive Map Modification Order as a byway open to all traffic and the X-K route be included as a public footpath.**

## **1.0 BACKGROUND**

- 1.1 By virtue of section 53 of the Wildlife and Countryside Act, 1981 the County Council is required to keep the Definitive Map and Statement under continuous review and make modification orders upon the discovery of evidence, which shows that the map and statement need to be modified.
- 1.2 The relevant statutory provision which applies to adding a public right of way to the Definitive Map and Statement, based on historical documentary evidence, is Section 53(3)(c)(i) of the Wildlife and Countryside Act, 1981. This requires the County Council (as Surveying Authority) to modify the Definitive Map and Statement following:

“the discovery by the authority of evidence which (when considered with all other relevant evidence available to them) shows:

“that a right of way which is not shown in the map and statement subsists or is reasonably alleged to subsist over land in the area to which the map relates, being a right of way such that the land over which the right subsists is a public path, a restricted byway or, subject to section 54A, a byway open to all traffic;”

- 1.3 All the relevant statutory provisions and competing rights and interests have been considered in making this report. The recommendations are in accordance with the law and proportionate, having regard to individuals' rights and the public interest.

## **2.0 PUBLIC EVIDENCE**

- 2.1 In the late 1980s the County Council carried out consultations regarding proposals to add a number of unsealed tracks in the north of the County to the Definitive Map as byways open to all traffic on the basis that the routes were included in the County Council's "List of Streets" as unclassified County roads (UCR). The rationale for doing so was that it would not be obvious to members of the public (particularly horse riders, walkers and cyclists) that they were legally entitled to use routes such as these (which were considered to have vehicular status), because their physical appearance might suggest otherwise.
- 2.2 The view, held by those officers of the Council responsible for maintaining the 'List of Streets' for the County of Northumberland was (and still is) that only public roads (not public bridleways or public footpaths) were shown on this List. The only exceptions to this are the surfaced paths and alleyways providing pedestrian links between roads, in urban streets. Thus, tracks in rural settings, which have their own unique reference numbers (e.g. the 'U4005' road), were considered to be all-purpose public highways maintainable at public expense.
- 2.3 Shortly afterwards, the processing of applications from third parties seeking to record public footpath or public bridleway rights was afforded a higher priority. Later on, the process of recording UCRs as byways open to all traffic was effectively suspended because the Ordnance Survey indicated that they would be showing such routes on their published maps as being an "Other route with

public access". Although, on that basis, members of the public would still be unclear as to precisely what rights they had over routes identified in this fashion.

- 2.4 The most recent advice from DEFRA (paragraph 4.42, Rights of Way Circular 1/09) is that inclusion on the List of Streets may provide evidence of vehicular rights but that this should be examined on a case by case basis. In view of this advice, it is considered prudent to evaluate the status of this spur of the U4005 unclassified County road based upon more than simply its inclusion in the List of Streets.

### **3. LANDOWNER EVIDENCE**

- 3.1 By note, received 19 September 2018, Mr L Farr of Lorbottle Weststeads responded to the consultation stating:

"Road J to K is Council road as they repair it."

### **4. CONSULTATION**

- 4.1 In February 2018, the Council carried out a consultation with the Parish Council, known owners and occupiers of the land, the local County Councillor and the local representatives of the "prescribed and local organisations" listed in the Council's "Code of Practice on Consultation for Public Path Orders". Two replies were received and are included below.
- 4.2 By email, on 26<sup>th</sup> February 2018, Ms H Evans responded to the consultation, on behalf of Cycling UK, stating:

"Ted has now looked at these and come back to me with the attached and also the comment that "Most are standard changes to confirm existing BOATs but a few are really good gains to the access network. No comment means we support and no comments are necessary".

Cycling UK did not make any comments in relation to this particular proposal.

- 4.3 By email, on 22<sup>nd</sup> February 2018, Ms S Rogers responded to the consultation, on behalf of the British Horse Society, stating:

"I am not able to give you an indication of the balance between motorised and other use, I am afraid. But, as I say, there is a real danger that these short UCRs which lead to farms and on-going footpaths and bridleways may be seen by the public to be private. I don't think many farmers realise how reticent the public are to use anything that might be private specially if it goes right past the farmhouse or buildings. Sadly this results in many ROW not being used as the public are put off from accessing them.

"I am not sure if that counts legally but it is certainly a point to bear in mind from the users' point of view.

“Callaly parish

Alleged Byway Open to All Traffic no 11 (Lorbottle Weststeads)

This is a single track tarmac road with a grass strip along its centre. It is partly unfenced and leads to a public footpath. There is no fingerpost in place at the start of that right of way. This needs to be rectified. It is suspected that there may be higher rights along this footpath. It is important that the public are aware that this is a public route and not just a farm access so the BHS supports its addition to the definitive map.”

**5. DOCUMENTARY EVIDENCE**

- 5.1 A search has been made of archives relating to the area. Evidence of Quarter Sessions Records, Council Highways records, County Maps and O.S. Maps was inspected, and the following copies are enclosed for consideration.

1769 Armstrong’s County Map

There is no evidence of a road or track approximating to the route of alleged Byway No 11.

1820 Fryer’s County Map

There is evidence of a road or track approximating to the route of alleged Byway No 11, with a north-westerly continuation to “Follyans”.

1827 Cary’s Map

There is evidence of a road or track approximating to the route of alleged Byway No 11, with a north-westerly continuation to “Follyans”.

1828 Greenwood’s County Map

There is evidence of a road or track approximating to the route of alleged Byway No 11, with a north-westerly continuation to “Folions”.

c.1860 Ordnance Survey Map: Scale 1:2500

There is clear evidence of an unenclosed road / track over the route of alleged Byway No 11. It is identified as parcel number “68” in Lorbottle township. In the accompanying Book of Reference, this parcel is identified as “Public road”.

1866 Ordnance Survey Map: Scale 1:10,560

There is evidence of a partly enclosed road / track over the route of alleged Byway No 11.

1899 Ordnance Survey Map: Scale 1:10,560

There is clear evidence of an unenclosed road / track over the route of alleged Byway No 11.

#### Finance Act 1910 plan

There is clear evidence of an unenclosed road / track over the route of alleged Byway No 11. The route is not, therefore, identified as being separate from the adjacent land by coloured boundaries. If it had been, this would have been a good indication that the road was considered to be public at that time. The route is, however, labelled as "Public Road".

#### 1926 Ordnance Survey Map: Scale 1:10,560

There is clear evidence of an unenclosed road / track over the route of alleged Byway No 11.

#### 1951 Highways Map

Most of the route of alleged Byway Open to All Traffic No 11 is coloured so as to identify it as a publicly maintainable road. Despite the small scale of the mapping, it would still appear that the road is depicted terminating slightly short of point X. It is labelled as a spur of the "U4005" Lorbottle - High Trehitt road.

#### c.1952 Definitive Map – original Survey Schedules & Map

The route of alleged Byway Open to All Traffic No 11 exists on the base map, and is coloured brown as far as Point X. Known public roads were generally coloured brown to indicate what the extent of the road network was considered to be. The X-K section is identified as being part of a public footpath numbered "1".

#### Draft Map

The route of alleged Byway Open to All Traffic No 11 exists on the base map. The vast majority of it is not identified for inclusion on the Definitive Map as either a public footpath, public bridleway or Road Used as a Public Path (RUPP), though two public footpaths (numbered "1" and "3") are identified connecting with the northern end of the alleged byway. Indeed, the X-K section is identified as being part of the public footpath numbered "1".

#### Provisional Map

As with the Draft Map, the route of alleged Byway Open to All Traffic No 11 exists on the base map. The vast majority of it is not identified for inclusion on the Definitive Map as either a public footpath, public bridleway or Road Used as a Public Path (RUPP), though two public footpaths (numbered "1" and "3") are identified connecting with the northern end of the alleged byway. Indeed, the X-K section is identified as being part of the public footpath numbered "1".

#### 1957 Ordnance Survey Map: Scale 1:10,560

There is clear evidence of an enclosed road / track over the route of alleged Byway No 11.

1962 Original Definitive Map

The route of alleged Byway No 11 exists on the base map, but is not identified as a public footpath, public bridleway or Road Used as a Public Path (RUPP). The two public footpaths previously identified as "1" and "3" have now been combined into a single footpath, now numbered "8". This footpath is depicted as connecting with alleged Byway No 11 route at Point K.

1964 Highways Map

The majority of the route of alleged Byway Open to All Traffic No 11 is coloured so as to identify it as a publicly maintainable road. Despite the small scale of the mapping, it would still appear that the road is depicted terminating slightly short of point X. It is labelled as part of the "U4005".

Undated County Highways Map: Scale 1:10,560

The route of alleged Byway Open to All Traffic No 11 is coloured so as to identify it as a publicly maintainable road. It is labelled as a spur of the "U4005". The route is identified as stopping at a field boundary immediately south-west of Lorbottle Weststeads.

Undated County Highways Map: Scale 1:2500

The route of alleged Byway Open to All Traffic No 11 is labelled as part of the "U4005" road. The route is identified as stopping at a field boundary immediately south-west of Lorbottle Weststeads.

1979 Ordnance Survey Map: Scale 1:10,000

There is clear evidence of an enclosed road / track over the route of alleged Byway No 11.

2005 Ordnance Survey Explorer 332 Map: Scale 1:25,000

There is clear evidence of an enclosed road / track over the route of alleged Byway No 11. The route is depicted as a yellow road.

2006 The Council's 'List of Streets' (2 May 2006)

The route of the alleged byway is clearly identified as publicly maintainable highway.

5.2 The entry for the U4005 road, in the 1958 County Road Schedule, states:

"U4005 High Trehitt - Lorbottle Road  
From C176 at High Trehitt to C178 at Lorbottle including the branch road to Lorbottle West Steads."

The length of the U4005 road is identified as 2.35 miles.

5.3 The entry for the U4005 road, in the 1964 County Road Schedule, states:

“U4005 High Trehitt - Lorbottle Road  
From C176 at High Trehitt eastwards to C178 at Lorbottle including  
the branch road to Lorbottle Weststeads.”

The length of the U4005 road is identified as 2.35 miles.

5.4 The entry for the U4005 road, in the 1974 County Road Schedule states:

“U4005 High Trehitt - Lorbottle Road  
From C176 at High Trehitt (NU 009055) eastwards to C178 at  
Lorbottle (NU 035065) including the branch road to Lorbottle  
Weststeads.”

The length of the U4005 road is identified as 2.35 miles.

5.5 The original Definitive Statement for the public right of way ‘intersecting’ with the alleged byway open to all traffic states:

Public Footpath No 8  
“From the Urchin’s Bank - Follions Road at Follions in a south-easterly  
and south-westerly direction by Lorbottle Weststeads to the Netherton  
Parish boundary joining FP 16 in that parish.”

## **6. SITE INVESTIGATION**

6.1 From Point J, on the U4005 road, 630 metres west of Lorbottle Square, a 2.7 metre wide tarmac road within a 7 to 7.3 metre wide ‘corridor’ (the eastern side is not really enclosed by a hard boundary) in a north-westerly direction for a distance of 590 metres. Thereafter, a 2.7 metre wide tarmac road within a 6 metre wide corridor continues in a north-westerly direction for a distance of 295 metres. Then a 3 metre wide rough tarmac / stone surfaced track, still within a 6 metre wide corridor, continues in a north-westerly direction for a further 25 metres to Point X, 30 metres south-west of Lorbottle Weststeads farmhouse.

6.2 The current List of Streets (and, also, the List of Streets as at 2 May 2006), depicts the U4005 spur continuing, in a westerly direction beyond Point X, for a further 25 metres to join Public Footpath No 8 at a field gate immediately west of a farm outbuilding (Point K). The width of this section isn’t particularly well defined, but it might best be described as a 3 to 4 metre wide stone surfaced track.

## **7. COMMENTS RECEIVED ON THE DRAFT REPORT**

7.1 In January 2020, a draft copy of the report was circulated to those landowners / occupiers who responded to the initial consultation for their comments. On 13 January 2020 Mr Farr telephoned to say that he agreed with the conclusions of the report.

## 8. DISCUSSION

- 8.1 Section 53 (3)(c)(i) of the Wildlife and Countryside Act 1981, requires the County Council to modify the Definitive Map when evidence is discovered which, when considered with all other relevant evidence available to them shows:
- that a right of way, which is not shown in the Map and Statement, subsists or is reasonably alleged to subsist over land in the area to which the Map relates, being a right of way such that the land over which the right subsists is a public path, a restricted byway or; subject to section 54A, a byway open to all traffic.
- 8.2 When considering an application / proposal for a modification order Section 32 of the Highways Act 1980 provides for “any map, plan or history of the locality or other relevant document” to be tendered in evidence and such weight to be given to it as considered justified by the circumstances, including the antiquity of the tendered document, the status of the person by whom and the purpose for which it was made or compiled, and the custody in which it has been kept and from which it is produced.
- 8.3 The representation of a path or track on an Ordnance Survey Map is not evidence that it is a public right of way. It is only indicative of its physical existence at the time of the survey.
- 8.4 The route of alleged Byway Open to All Traffic No 25 is identified on the County Council’s current List of Streets as being a spur of the U4005 road. The route appears to have been identified on both the Council’s 1951 Highways Map and the later 1964 Highways Map. It was also included in the 1958, 1964 and 1974 County Road Schedules. No 1932 Handover Maps or Maps / Schedules produced under the Restriction of Ribbon Development Act 1935 appear to have survived for the former Rothbury Rural District Council area.
- 8.5 The route has been consistently identified as a partly unenclosed road / track on Ordnance Survey maps since c.1860. Although the route is not shown on Armstrong’s County Map of 1769, it is depicted on Fryer’s and Greenwood’s County Maps of 1820 and 1828, and on Cary’s Map of 1827. It is clearly identified as a public road on the plan produced in relation to the Finance Act 1910.
- 8.6 Although other public rights of way were identified nearby, and one public footpath appears to make a junction with the alleged byway route itself, only the most northerly 25 metres of the route was included on the Draft and Provisional Maps as a footpath, bridleway or Road Used as Public Path (RUPP). When the Definitive Map was published the public footpath was shortened, slightly, so that it no longer made a junction with the U4005 road at Lorbottle Weststeads. This was almost certainly a drafting error. The preceding Provisional Map clearly showed the footpath (then identified as two separate paths) connecting with the road. Without any change being ‘authorised’ as a result of a successful challenge at the Provisional Map stage, the Definitive Map ought to have reflected this alignment. Conversely, the current List of Streets appears to show the publicly maintainable road (U4005)



extending slightly too far north (to join the public footpath at Point K). This northerly extension, beyond Point X, would not appear to be supported by the historical documentary evidence. The U4005 ought to be trimmed back to Point X. On the initial Survey Map, the route is coloured brown in the same way that other public roads were identified.

- 8.7 The County Council accepts that, given the way the regulations were written with regard to the way highway authorities could include publicly maintainable highways in the List of Streets, there was no impediment to public bridleways and public footpaths also being included. That is not to say that any bridleways or footpaths were so shown – just that they could be. It must, therefore, be entirely proper to consider each UCR on a case by case basis, but that does not mean that we should begin with the assumption that each UCR is no more than a public footpath unless higher rights can be proven by other means. In Northumberland there is no evidence to suggest that public footpaths and public bridleways were deliberately shown on the 1958, 1964 or 1974 County Road Schedules (forerunners of the modern day List of Streets). The fact that a route is shown on these schedules must, therefore, be evidence of some weight that public vehicular rights exist.
- 8.8 Letters from DEFRA, dated 2003 and November 2006, and Rights of Way Circular 1/09 set out the approach Inspectors and order making authorities should take in determining the status of routes included on the List of Streets. In summary, the guidance states that the inclusion of a route on the List of Streets is not a record of what legal rights exist over that highway but may provide evidence of vehicular rights. However, this must be considered with all other relevant evidence in order to determine the nature and extent of those rights. Highway Authorities are recommended to examine the history of such routes and the rights that may exist over them on a case by case basis in order to determine their status.
- 8.9 The Natural Environment and Rural Communities Act 2006 (NERC Act 2006) had a major impact upon the recording of byways open to all traffic based upon historical documentary evidence. Under section 67 of the Act, any existing, but unrecorded, public rights of way for mechanically propelled vehicles were extinguished unless one of the 'saving' provisions applied. In brief, these saving provisions were: (a) if the main lawful public use between 2001 and 2006 was with motor vehicles; (b) if the route was on the List of Streets (on 2 May 2006) and not also on the Definitive Map as something less than a byway open to all traffic; (c) the route was legally created expressly for motor vehicular use; (d) the route was a road deliberately constructed for public motor vehicular use; or (e) the vehicular highway came about as a result of unchallenged motor vehicular use before December 1930.
- 8.10 Of the saving provisions above, (b) will apply to the route of alleged Byway No 11. The public's motor vehicular rights would not have been extinguished by the NERC Act 2006.
- 8.11 For a route to be a byway open to all traffic, it has to be (i) a public motor vehicular right of way and (ii) a route which is nevertheless used (or is likely to be used) by the public mainly for the reasons which footpaths and bridleways are used.
- 8.12 Although this route has a drivable surface, it is not in a very good condition,



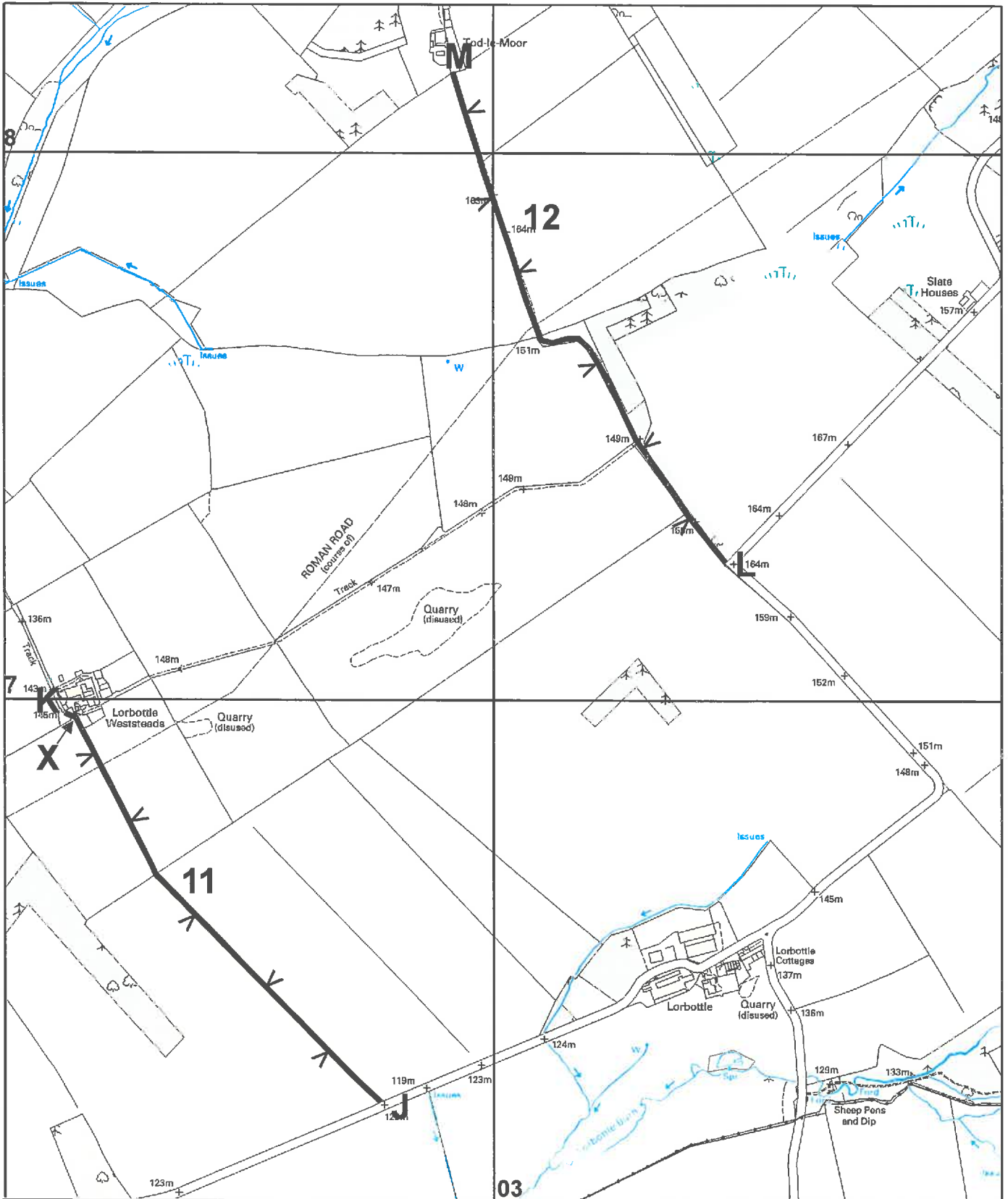

  
**Northumberland**  
 County Council

**Infrastructure**  
 Local Services Group  
 County Hall Morpeth Northumberland  
 Telephone 0845 600 6400 NE61 2EF

Reproduced from / based upon Ordnance Survey material with the permission of Ordnance Survey on behalf of the Controller of H.M.S.O. Crown Copyright. Unauthorised reproduction infringes Crown Copyright and may lead to prosecution or civil proceedings. Northumberland County Council O.S. Licence No 100049048

## Wildlife and Countryside Act 1981 Public Rights of Way

 Alleged Byway Open to All Traffic

Former District(s) Alnwick	Parish(es) Callaly	Scale 1:10,000
Def. Map No. 79	O.S. Map NU 00 NW	Date January 2020

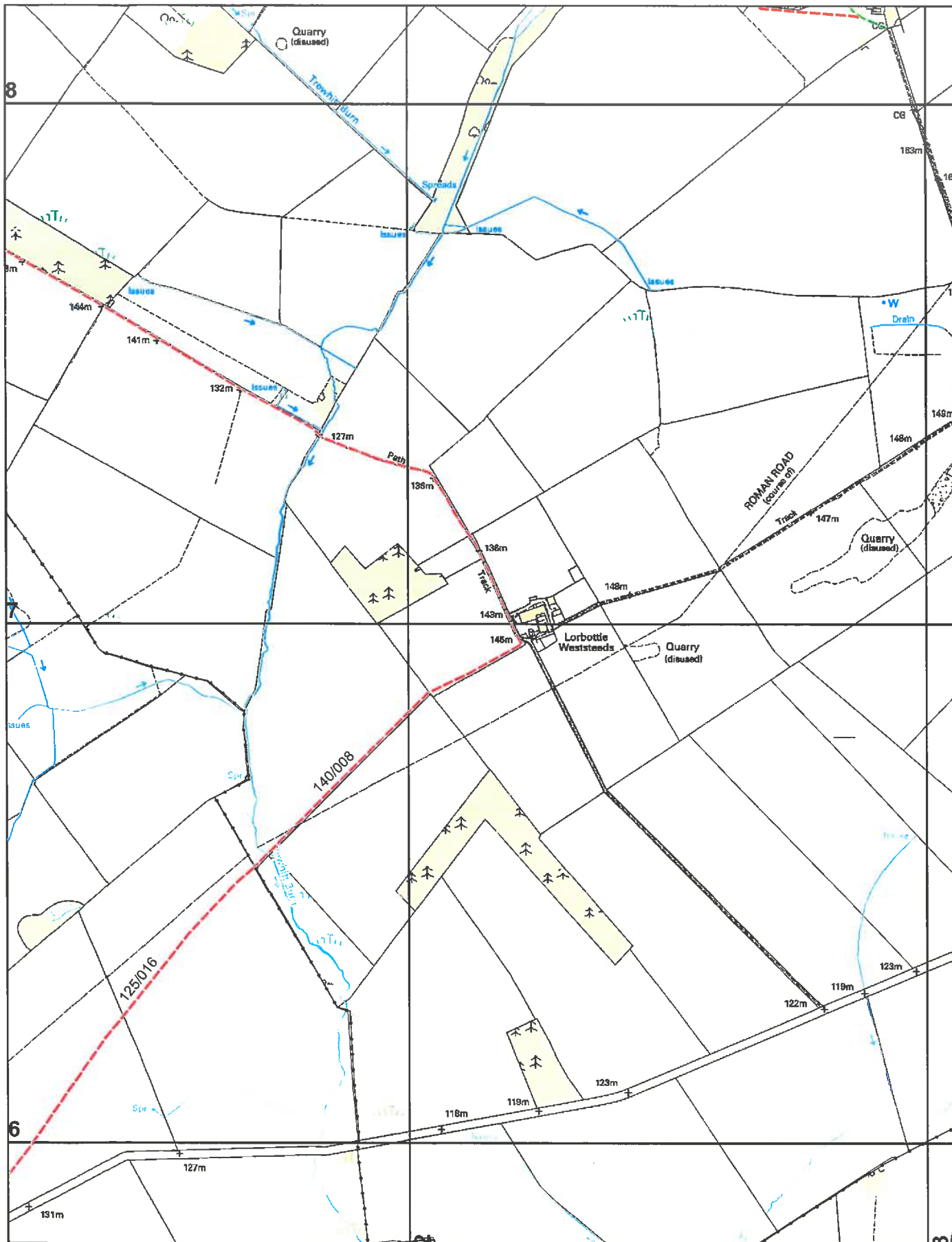

Contact: Alex Bell  
 Telephone: 01670 624133  
 Email: Alex.Bell@northumberland.gov.uk

**Legend**

- Footpath
- Bridleway
- Restricted Byway
- Byway Open to All Traffic

This is a computer generated extract of the Working Copy of the Definitive Map of Public Rights of Way

Scale: 1:10,000

This map is reproduced from Ordnance Survey material with the permission of Ordnance Survey on behalf of the Controller of Her Majesty's Stationary Office Crown Copyright. Unauthorised reproduction infringes Crown Copyright and may lead to prosecution or civil proceedings. License no. 100049048 (2010).

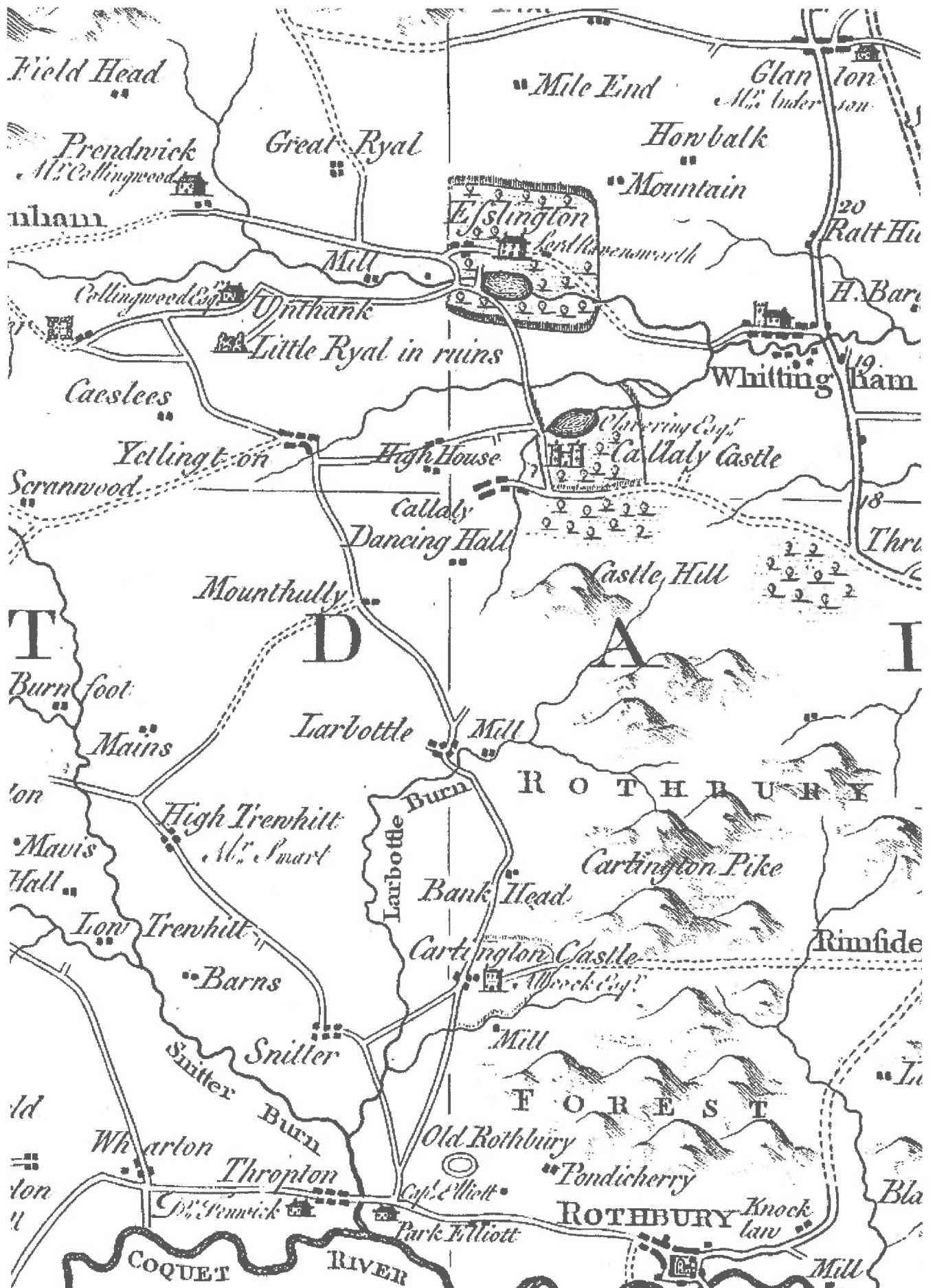





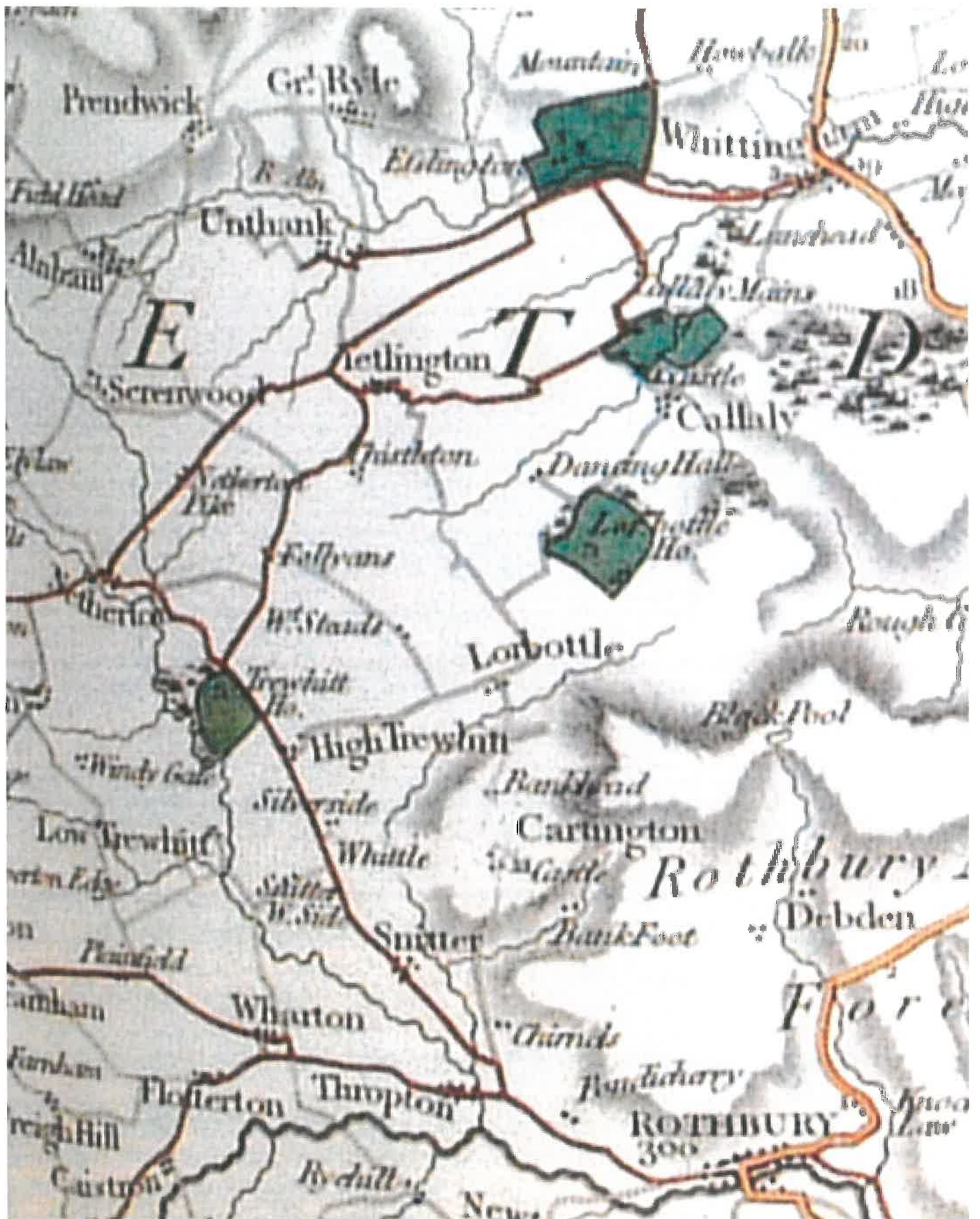





1st Edition 25" O.S. Map  
c.1860

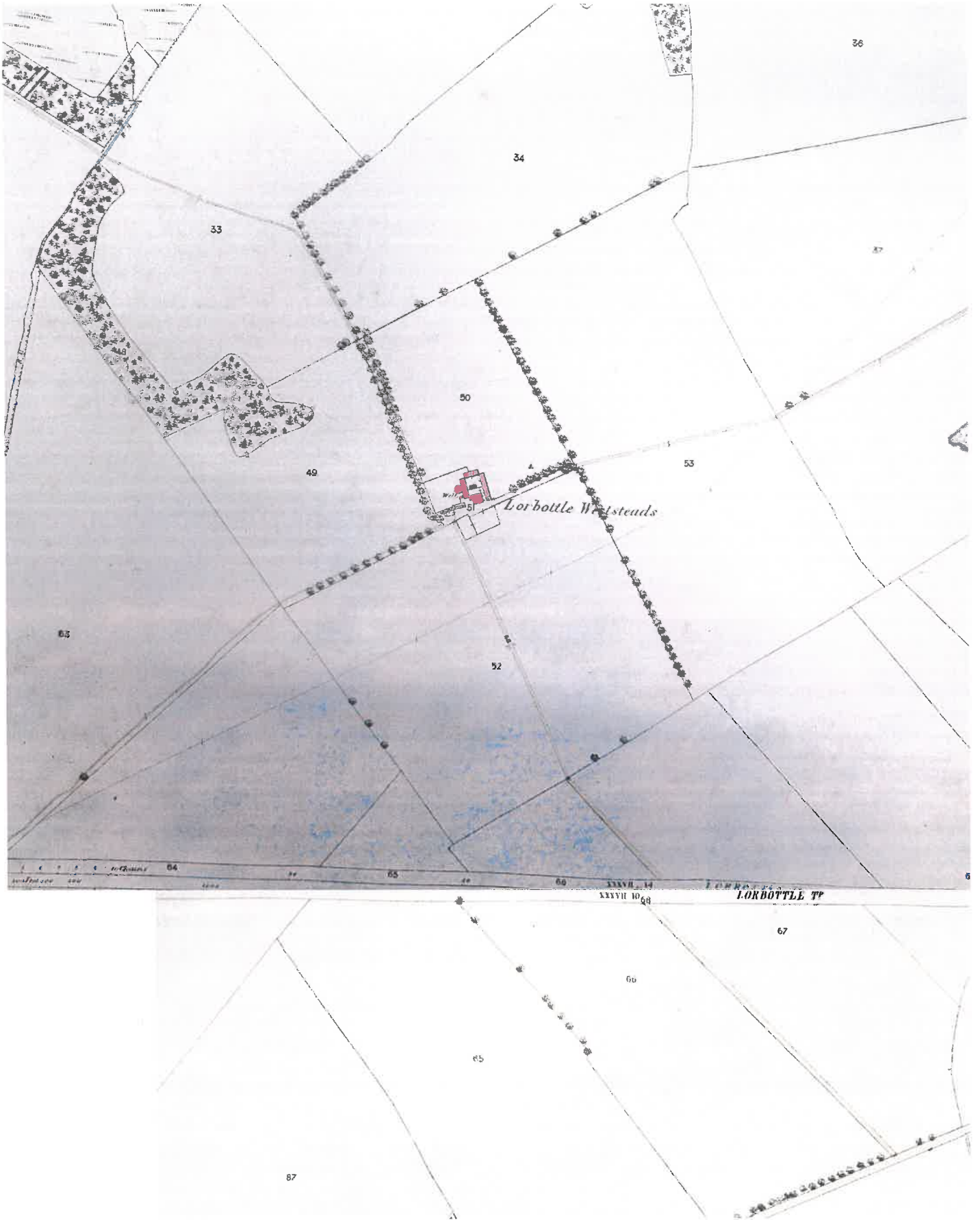

PARISH OF WHITTINGHAM.

No. of Plot	Area in Acres	Remarks	No. of Plan	Area in Acres	Remarks
45	68.748	Brought forward.	11	113.386	Brought forward.
46	16.010	Pasture.	12	6.838	Wood, &c.
47	1.169	Wood, &c.	13	25.263	Wood, &c.
48	3.240	Arable.	14	1.427	Gardens, &c.
49	14.081	Pasture, &c.	15	.178	Houses, &c. (Lodge)
50	21.203	Wood, &c.	16	3.475	Pasture, &c.
51	.104	Pasture and shed.	17	.012	House, &c.
52	2.988	Wood, &c.	18	.226	Wood.
53	7.388	Pasture, &c.	19	.226	House, yards, &c.
54	14.397	Pasture.	20	.455	Pasture.
55	12.551	Arable.	21	.600	Wood.
56	1.818	Wood.	22	6.947	Wood.
57	64.577	Pasture, &c.	23	18.880	Pasture, &c.
58	1.698	Wood.	24	43.541	Arable.
59	1.208	Houses, garden, &c. (Caisley Bluehouse, P.H.)	25	.123	Houses and garcans.
60	.090	Public road.	26	31.243	Pasture, trees, &c.
61	1.001	Pasture, &c.	27	.363	Houses, garden, &c.
62	.218	Garden.	28	4.304	Wood.
63	19.132	Pasture.	29	73.510	Rough pasture, &c.
64	527.511		30	1.869	Wood, &c.
65			31	33.203	Wood, &c.
66			32	8.215	Wood.
67			33	25.827	Arable, &c.
68			34	20.728	Pasture, &c.
69			35	22.181	Arable.
70			36	2.416	Wood.
71			37	20.806	Pasture, &c.
72			38	23.702	Pasture, &c. (Kiln House).
73			39	.583	House, garden, &c.
74			40	2.647	Pasture, &c.
75			41	2.223	Arable.
76			42	16.985	Pasture, &c.
77			43	38.941	Pasture, quarry, &c.
78			44	17.598	Arable and quarry.
79			45	.378	Wood.
80			46	3.264	Public road.
81			47	42.839	Arable.
82			48	37.446	Pasture, &c.
83			49	13.970	Arable, &c.
84			50	3.493	Wood, &c.
85			51	11.698	Pasture, &c.
86			52	8.109	Pasture.
87			53	1.217	Houses, yards, garcans, &c. (Lodge)
88			54	27.047	Arable, &c.
89			55	31.326	Arable, &c.
90			56	751.999	Carried forward.

RECAPITULATION.

Land.	518.675
Public roads.	8.697
Water.	.289
Total area of the Township of Little Ryle.	527.511

TOWNSHIP OF LORBOFFLE.

Wood, &c.	3.179
House (Lodge).	4.406
Wood, &c. (Howdon Plantation).	.014
Public road.	12.248
Wood, &c.	3.978
Ornamental ground.	11.801
Wood, &c.	39.736
Pasture, &c.	3.031
Pasture.	16.883
Public road.	18.310
Carried forward.	113.386

PARISH OF WHITTINGHAM.

No. of Plot	Area in Acres	Remarks	No. of Plan	Area in Acres	Remarks
1	6.027	Pasture, &c.	1	6.027	Pasture, &c.
2	.649	Wood.	2	.649	Wood.
3	1.367	Pasture, &c.	3	1.367	Pasture, &c.
4	2.252	Wood, &c.	4	2.252	Wood, &c.
5	.160	Wood, &c.	5	.160	Wood, &c.
6	3.489	Wood, &c.	6	3.489	Wood, &c.
7	10.063	Arable.	7	10.063	Arable.
8	12.001	Arable.	8	12.001	Arable.
9	2.550	Wood.	9	2.550	Wood.
10	2.283	Wood, &c.	10	2.283	Wood, &c.
11	9.045	Pasture, &c.	11	9.045	Pasture, &c.
12	3.434	Public road.	12	3.434	Public road.
13	16.179	Arable.	13	16.179	Arable.
14	14.460	Arable.	14	14.460	Arable.
15	20.613	Arable.	15	20.613	Arable.
16	15.411	Pasture.	16	15.411	Pasture.
17	1.921	Public road.	17	1.921	Public road.
18	.086	Wood, &c.	18	.086	Wood, &c.
19	8.840	Wood, &c.	19	8.840	Wood, &c.
20	.400	Houses, gardens, &c.	20	.400	Houses, gardens, &c.
21	.072	Public road.	21	.072	Public road.
22	.856	Pasture.	22	.856	Pasture.
23	2.416	Houses, yards, garcans, &c. (Little Ryle).	23	2.416	Houses, yards, garcans, &c. (Little Ryle).
24	2.122	Pasture, &c.	24	2.122	Pasture, &c.
25	17.000	Arable, &c.	25	17.000	Arable, &c.
26	16.898	Arable, &c.	26	16.898	Arable, &c.
27	1.618	Pasture.	27	1.618	Pasture.
28	2.826	Wood.	28	2.826	Wood.
29	7.492	Wood.	29	7.492	Wood.
30	11.882	Pasture.	30	11.882	Pasture.
31	16.627	Pasture.	31	16.627	Pasture.
32	2.539	Wood, &c.	32	2.539	Wood, &c.
33	2.693	Pasture.	33	2.693	Pasture.
34	8.948	Arable.	34	8.948	Arable.
35	.289	Pond.	35	.289	Pond.
36	8.380	Pasture, &c.	36	8.380	Pasture, &c.
37	24.003	Arable.	37	24.003	Arable.
38	20.082	Pasture, quarries, &c.	38	20.082	Pasture, quarries, &c.
39	18.692	Arable.	39	18.692	Arable.
40	8.199	Wood.	40	8.199	Wood.
41	9.750	Arable.	41	9.750	Arable.
42	34.270	Pasture, &c.	42	34.270	Pasture, &c.
43	1.674	Public road.	43	1.674	Public road.
44			44		
45	838.748	Carried forward.	45	838.748	Carried forward.

TOWNSHIP OF LITTLE RYLE.

Land.	1059.958
Public roads.	8.283
Water.	.269
Total area of the Township of Little Ryle.	1068.510

TP. OF GREAT RYLE (Det.)  
PARISH OF WHITTINGHAM (Detached).  
(Locality situated in the Ph. of Abham.)

1	21.654	Rough pasture, &c.
2	2.495	Wood.
3	12.047	Arable, road, &c.
4	1.279	Arable.
5	1.505	Arable, road, &c.
6	.187	Arable and stream.
7	.201	House, &c.
8	.702	Arable.
9	.602	River Ereamish.
10	943.175	

RECAPITULATION.

Land.	942.573
Water.	.602
Total area of Great Ryle Township.	943.175

RECAPITULATION FOR THE TP.

Land.	2032.941
Public roads.	3.598
Water.	.971
Total area of Great Ryle Township.	2037.510



PARISH OF WHITTINGHAM.

No on Plan	Area in Acres.	Remarks.	No on Plan.	Area in Acres.	Remarks.
		<i>Brought forward.</i>			<i>Brought forward.</i>
22	288.111	Arable.	66	624.546	Arable.
23	28.225	Pasture.	67	19.743	Pasture.
24	15.208	Arable.	68	4.081	Pasture.
25	12.987	Arable.	69	6.490	Public road.
26	15.162	Pasture.	70	29.780	Pasture.
27	15.601	Wood.	71	46.199	Arable.
28	1.400	Wood, &c.	72	1.084	Wood.
29	1.479	Pasture, &c.	73	2.217	Public road.
30	26.232	Pasture, &c.	74	28.577	Pasture.
31	20.288	Public road.	75	21.630	Pasture.
32	1.376	Wood (Cat Plantation).	76	7.453	Pasture.
33	1.441	Pasture.	77	.267	Wood.
34	23.351	Public road.	78	1.765	Arable, &c.
35	1.440	Wood, &c.	79	.818	House, pasture, &c.
36	2.845	Pasture and trees.	80	25.999	Arable.
37	8.711	Arable, &c.	81	14.902	Arable.
38	7.137	Garden.	82	86.943	Arable, &c.
39	.080	Garden.	83	26.148	Ornamental ground.
40	.069	Garden.	84	6.181	Public road.
41	.077	Houses, yards, &c.	85	1.785	Wood, &c.
42	1.455	(Shawdon wood House).	86	25.405	Ornamental ground.
43	.219	Pond.	87	.114	Pasture.
44	.794	Pasture, &c.	88	.135	House and pasture.
45	9.040	Houses and gardens.	89	.240	Wood and gravel pit.
46	.599	Wood, &c.	90	.909	Houses, yard, &c. (Shawdon Hall).
47	.329	Pasture, &c.	91	6.176	Pasture, &c.
48	32.103	Wood.	92	1.229	Pasture and shed.
49	.569	Wood.	93	23.657	Arable.
50	.081	Wood.	94	36.555	Pasture, old quarry, &c.
51	37.677	Pasture, &c.	95	.056	Garden.
52	8.807	Pasture, &c.	96	.086	House, &c. (Lodge).
53	.841	Pasture, &c.	97	1.844	Wood, &c.
54	21.565	Arable.	98	25.873	Ornamental ground.
55	.699	Wood, &c.	99	.921	Wood.
56	.578	Wood, &c.	100	.009	House (Lodge).
57	1.231	Wood, &c.	101	1.047	Fish-pond.
58	19.272	Arable, &c.	102	1.411	Gardens, &c.
59	1.468	Wood.	103	.056	Pasture and conservatory.
60	8.744	Pasture and trees.	104	10.399	Wood, &c.
61	19.275	Brushwood, &c.	105	23.507	Arable, &c.
62	2.518	Pasture, &c.	106	10.778	Houses, yards, &c.
63	1.661	House, garden, &c.	107	1.855	Houses, yards, &c. (Shawdon Hill).
64	.127	Wood, &c.	108	27.459	Pasture.
65	37.849	Wood, &c.	109	2.914	Public road.
	624.546	<i>Carried forward.</i>		1113.355	<i>Carried forward.</i>

PARISH OF WHITTINGHAM.

No on Plan.	Area in Acres.	Remarks.
		<i>Brought forward.</i>
54	751.509	Arable, &c.
55	24.024	Arable, &c.
56	30.031	Arable, &c.
57	15.044	Arable, &c.
58	12.548	Arable.
59	8.911	Pasture, &c.
60	2.137	Wood, &c.
61	3.005	Wood, &c.
62	3.257	Wood, &c. (Waterloo Plantation).
63	1028.159	Rough pasture, rocks, &c.
64	31.662	Pasture, &c.
65	33.099	Arable, &c.
66	31.857	Pasture.
67	25.139	Arable.
68	27.322	Arable.
69	1.847	Public road.
70	29.505	Arable, &c.
71	16.706	Pasture.
72	44.413	Arable, &c.
73	.435	Pond.
74	.242	Pasture.
75	1.776	Houses, yards, gardens, &c.
76	.768	Houses, garden, &c. (Lorboffle).
77	.099	Pond.
78	.501	Houses, gardens, &c.
79	.202	House, garden, &c.
80	.875	Public road.
81	11.253	Arable.
82	21.094	Arable.
83	2.825	Wood.
84	3.675	Wood, &c.
85	22.603	Furze, &c.
86	45.285	Rough pasture and furze.
87	4.440	Wood.
88	27.558	Arable.
89	1.278	Wood.
90	.179	Wood.
91	35.015	Pasture, &c.
92	29.695	Pasture, &c.
93	.451	Wood.
94	28.498	Pasture, furze, &c.
95	.508	Wood.
96	5.782	Pasture, &c.
97	39.789	Pasture, furze, &c.
98	.639	Wood.
	2416.014	<i>Carried forward.</i>

  

RECAPITULATION.		
2421.218	Land.	
14.964	Public roads.	
.534	Water.	
2436.716	Total area of the Township of Lorboffle.	

TOWNSHIP OF SHAWDON AND WOODHOUSE.		
1	19.725	Pasture.
2	2.125	Public road.
3	15.999	Arable.
4	2.492	Public road.
5	53.650	Pasture, quarry, &c.
6	.148	Wood.
7	.088	Wood.
8	.350	Ruins, &c. (Shepherds Law).
9	.340	Pasture and trees.
10	27.435	Wood, &c. (Shepherds-law Plantation).
11	14.699	Pasture, &c.
12	1.660	Wood.
13	2.230	Wood.
14	.327	Private road.
15	15.666	Wood.
16	17.919	Rough pasture and trees.
17	26.807	Wood.
18	.819	Wood, &c.
19	5.664	Wood, &c.
20	18.529	Arable.
21	12.004	Arable.
	288.111	<i>Carried forward.</i>



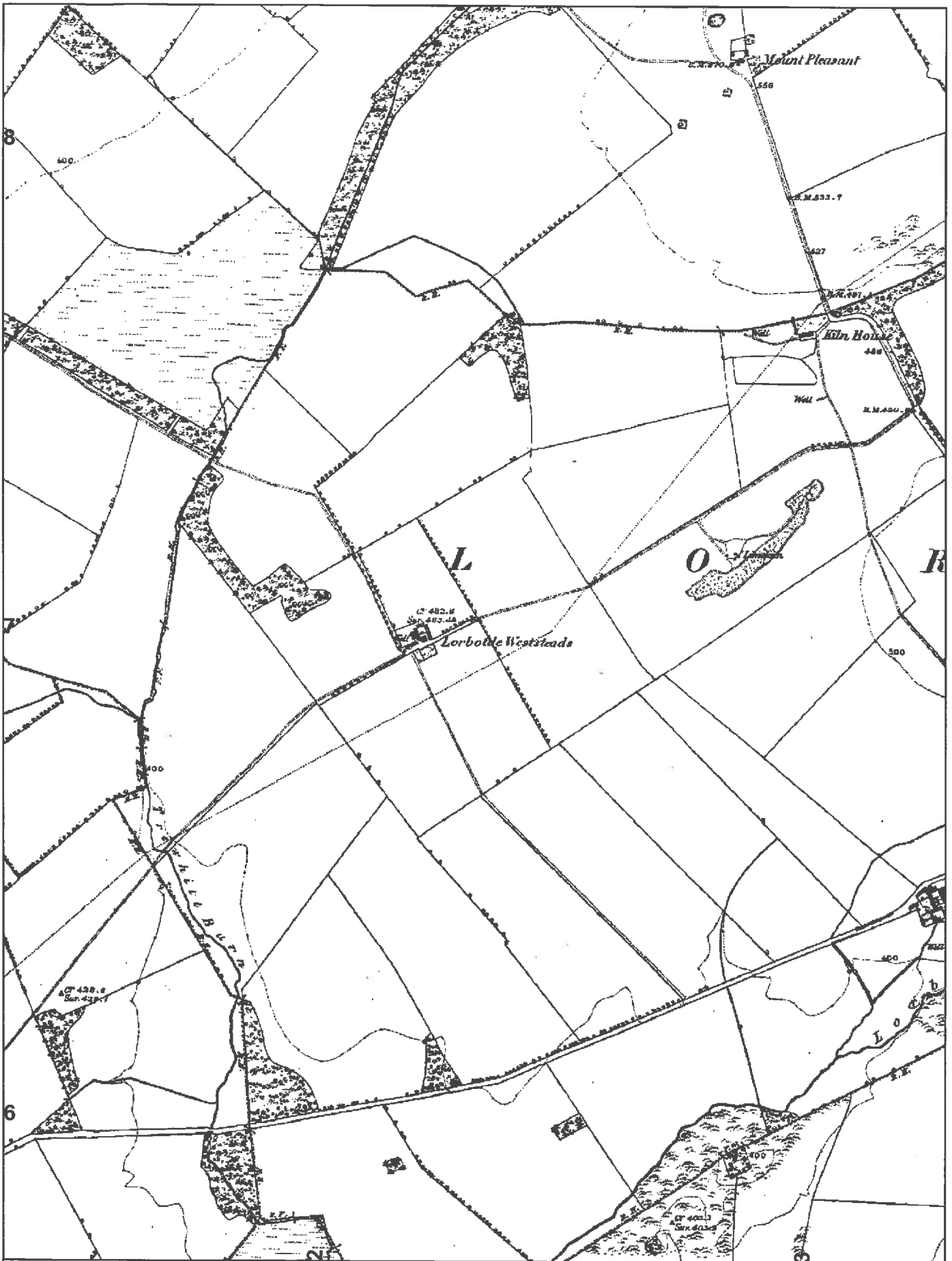

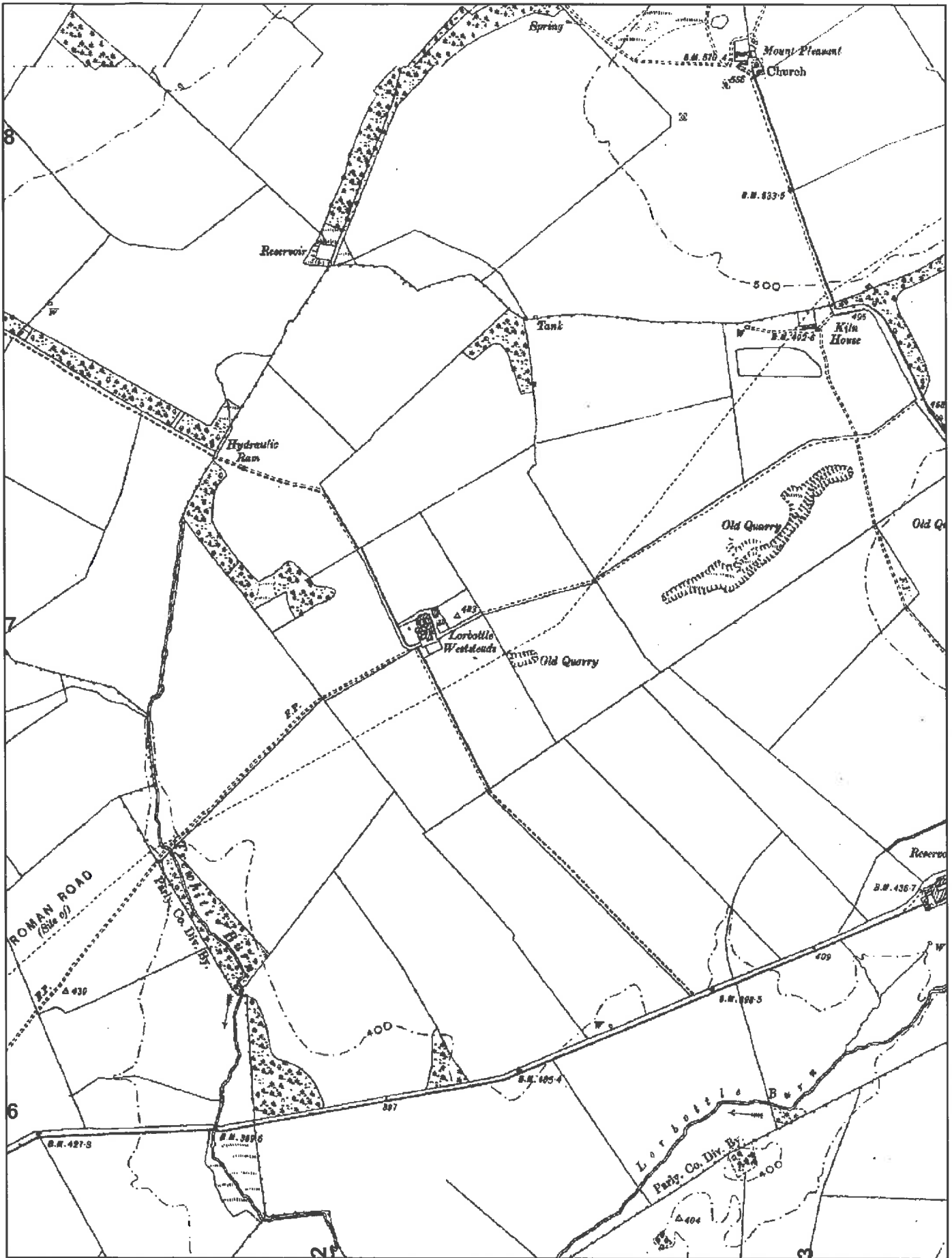



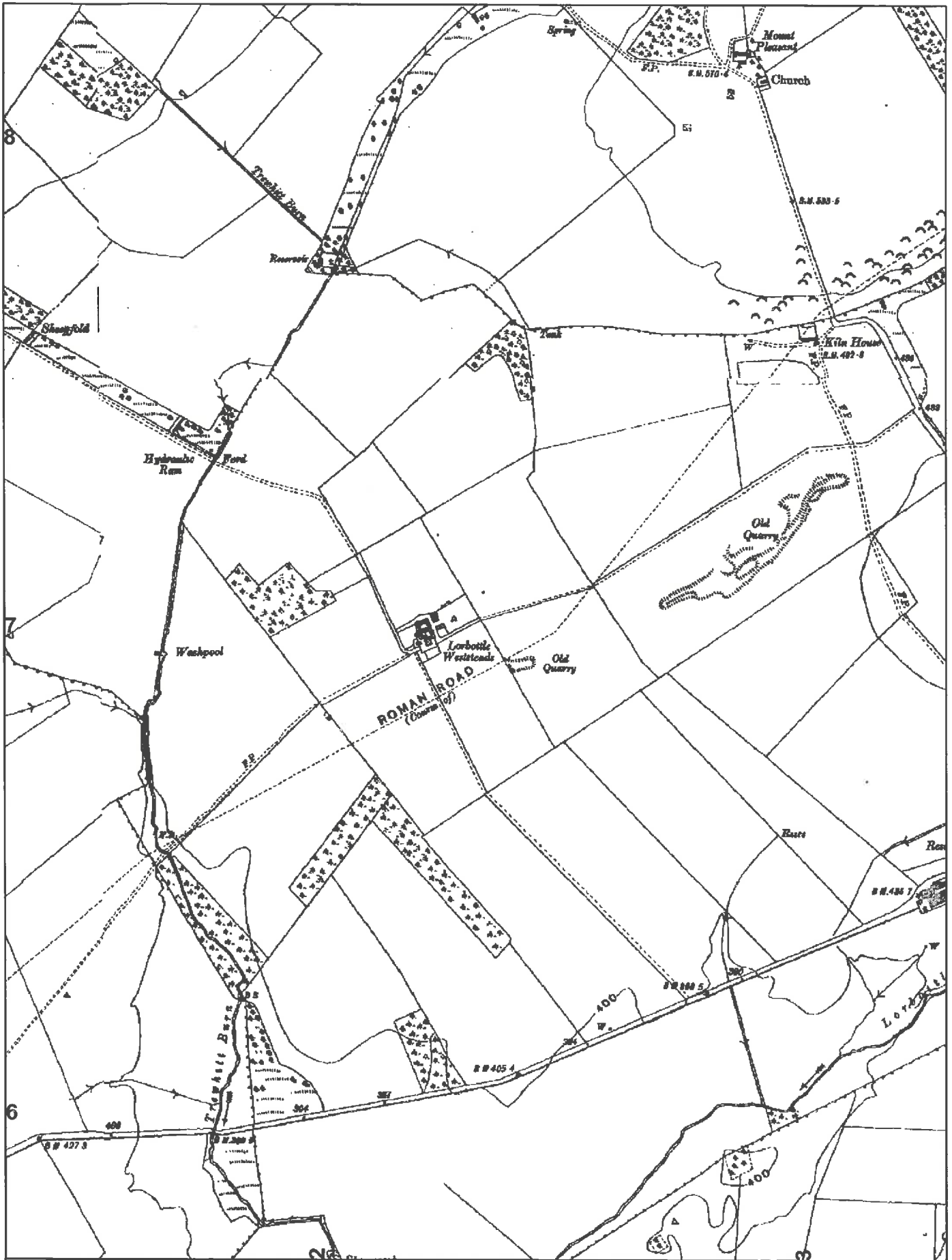



Extract from the Council's 1951 Highways Map

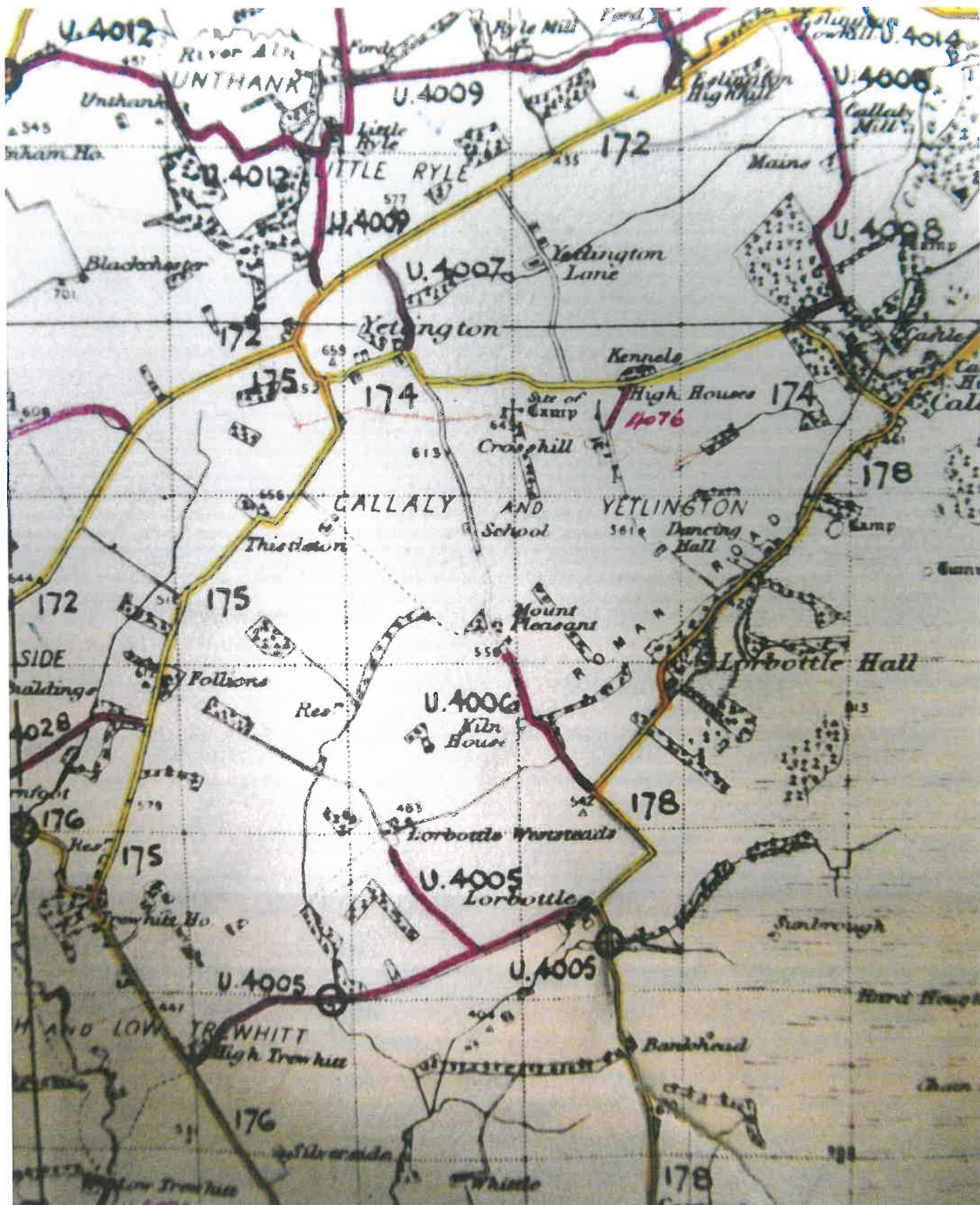



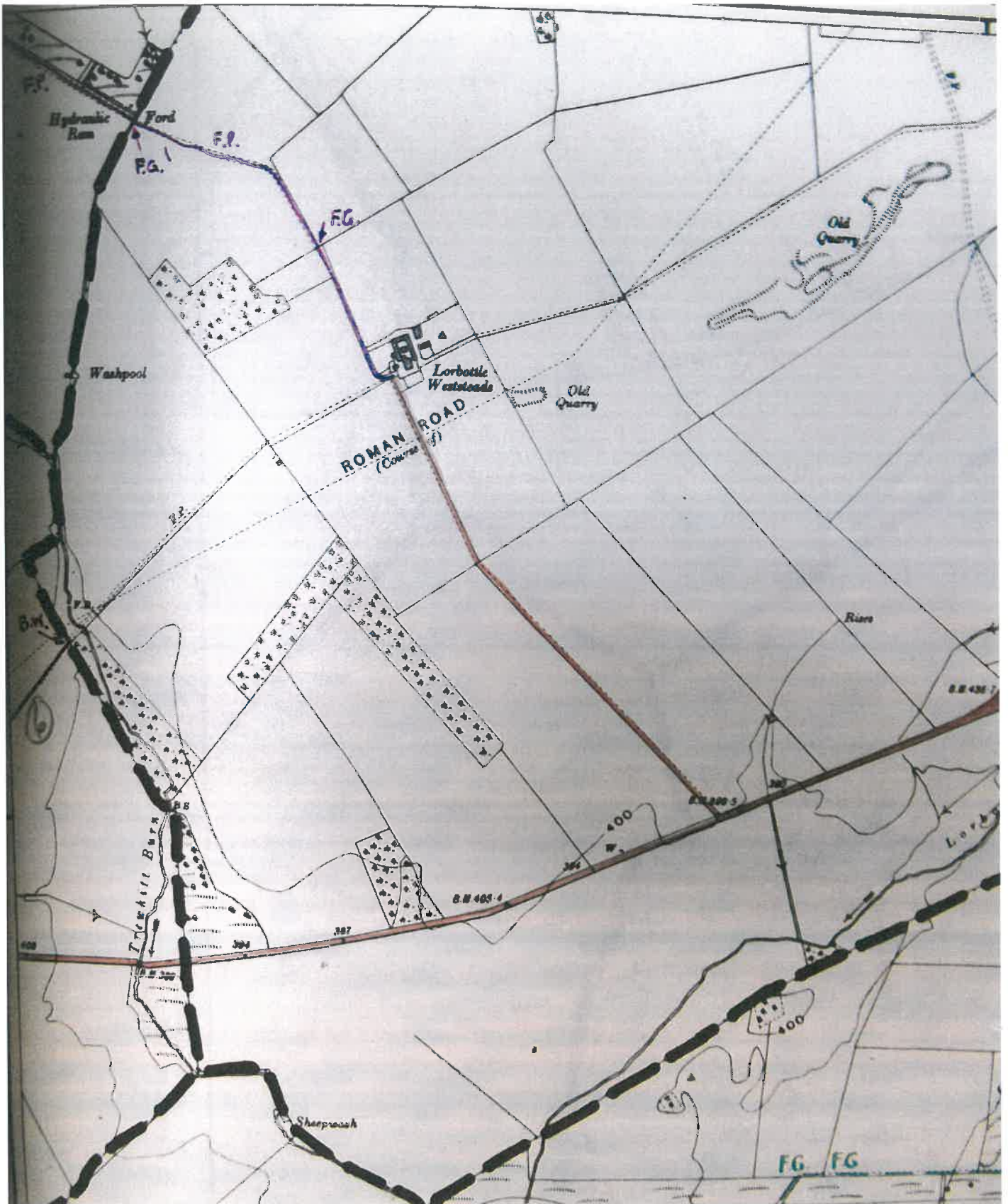

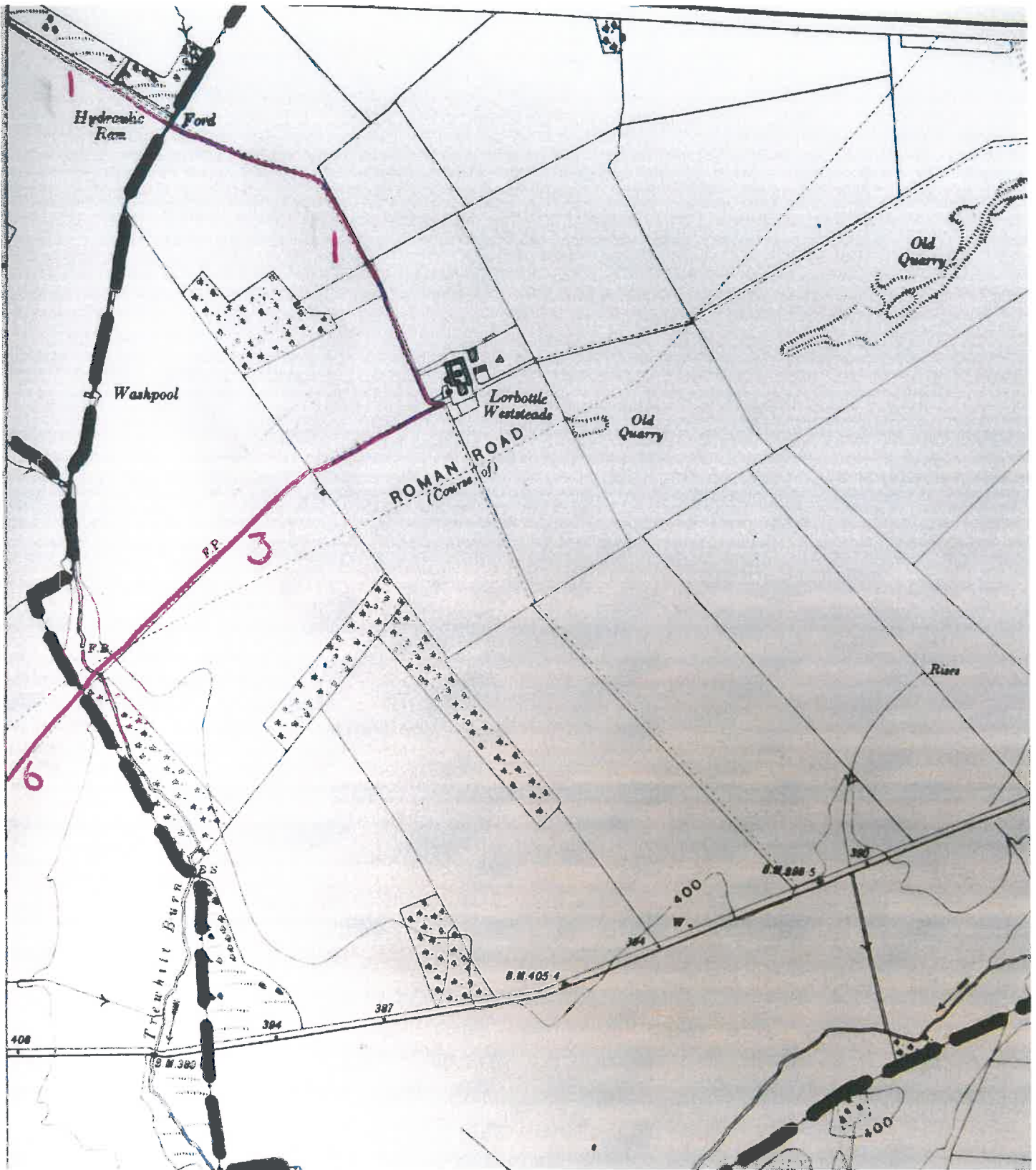



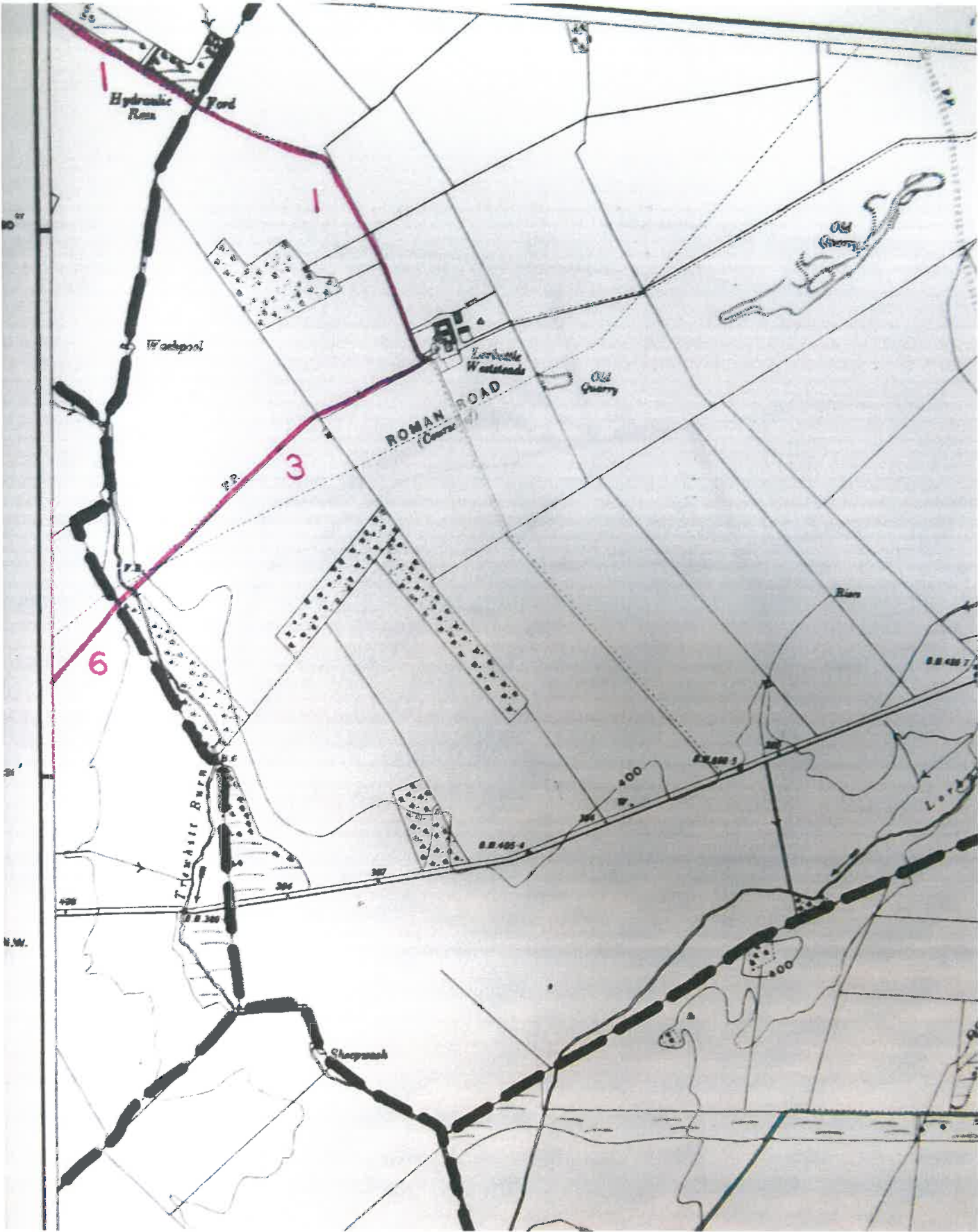



# 1958 County Road Schedule

## ALWICK DIVISION

### Unclassified Roads in Rothbury Rural District

U.4001	Rothhill - Middle Barton Road	From C.90 at Rothhill via Middle Barton to the Rothbury and Alwicks R.D. boundary south-west of Shawdon Hill Cottage.	1.11
U.4002	Whittingham - Thrunton - Whittingham Station Road	From C.90 south-east of Whittingham Crossing A.697 east of Thrunton to Class C.90 east of Whittingham Station.	2.38
U.4003	Thrunton Mill Road	From C.90 west of Mount Holly to the Swine Burn at Thrunton Mill.	0.36
U.4004	Thrunton Red House - Wendysteads.	From U.4002 south-west of Thrunton via Thrunton Red House and Car Burn Bridge to A.697 north of Wandysteads.	2.40
U.4005	High Trehitt - Larbottle Road	From C.176 at High Trehitt to C.178 at Larbottle including the branch road to Larbottle West Steads.	2.35
U.4006	Larbottle - Mount Pleasant Road	From C.178 south-west of Larbottle Hall to Church at Mount Pleasant.	0.67
U.4007	Yetlington North Road	From C.174 at Yetlington northwards to C.172	0.37
U.4008	Callaly - Eslington Low Hill Road	From C.174 west of Callaly North Lodge to C.172 at Eslington Low Hill.	1.29
U.4009	Urchins Bank - Eslington Hall Road	From C.172 north-east of Urchins Bank via Little Ryal and Eslington Hall to C.172 east of Eslington Low Hill.	3.03
U.4010	Eslington Hall West Lodge - Mere Burn Road.	From C.172 at Eslington High Hill via Eslington Hall West Lodge to C.169 at its crossing at the Mere Burn.	0.88
U.4011	Great Ryal - Aln Fordway Road.	From C.169 at Great Ryal to U.4009 at the River Aln Fordway north of Little Ryal.	0.75
U.4012	Alnham - Little Ryal Road	From C.169 north-east of Alnham to U.4009 south of Little Ryal	1.48
U.4013	Whittingham - Mountain Road	From C.90 north-west of Whittingham to U.4014 at The Mountain.	1.20
U.4014	Eslington Low Hill - Mile End Road.	From C.172 at Eslington Low Hill to C.169 southwest of Mile End.	1.14

Forward

19.410 miles



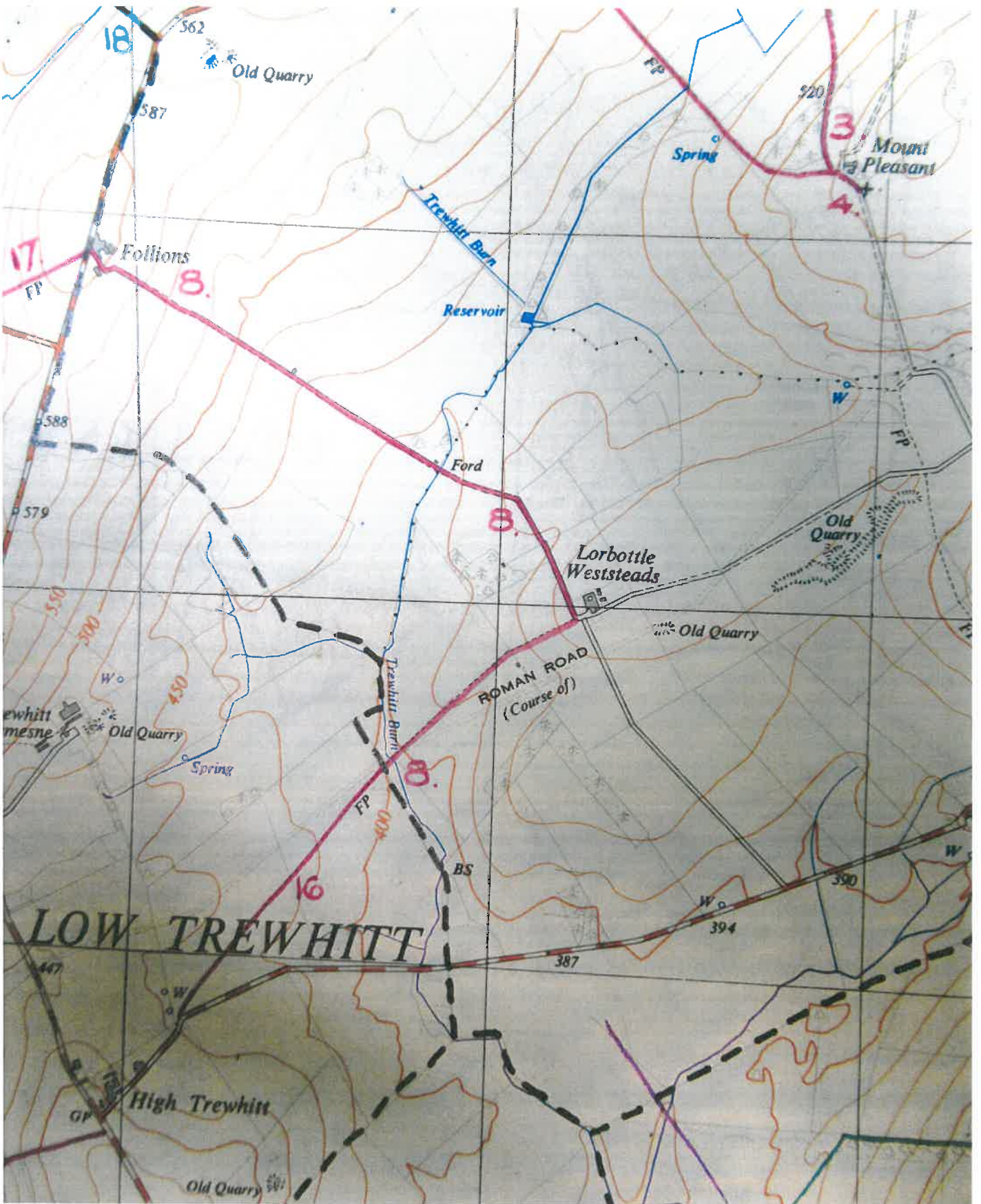

NORTHUMBERLAND COUNTY COUNCIL.

NATIONAL PARKS AND ACCESS TO THE COUNTRYSIDE ACT, 1949.  
PART IV.

PUBLIC RIGHTS OF WAY - STATEMENT.

1. ~~Borough~~ .....  
~~Urban district~~ .....  
Rural district ..... ROTHBURY
2. Parish ..... CALLAIT
3. Number of Footpath on Map ..... 8
4. Name of Path .....
5. Kind of Path (i.e. (FP/BR) ..... F.P.

6. General Description of Path From the Urehin's Bank - Follions Road at .....  
Follions in a south-easterly and south-westerly direction by Lorbottle Weststeads  
to the Netherton Parish boundary joining F.P.16 in that parish. .....  
.....  
.....  
.....

7. Other relevant information .....  
.....  
.....  
.....  
.....

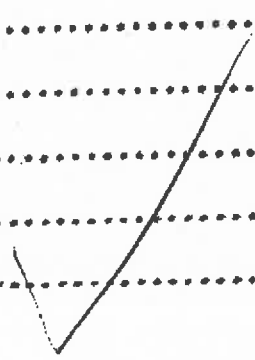

# 1964 County Road Schedule

-- 83 --

<u>Route No.</u>	<u>Name of Road.</u>	<u>Description.</u>	<u>Responsible Division or Authority.</u>	<u>Mileage.</u>	<u>Total Mileage.</u>
U.4001	Rothill-Middle Barton Road.	From C.90 at Rothill eastwards via Middle Barton to the Alnwick Rural District boundary south-west of Shawdon Hill Cottage. (Continues in Alnwick Rural District as U.3061).	Alnwick.	1.11	1.11
U.4002	Whittingham-Thrunton-Whittingham Station Road.	From C.90 south-east of Whittingham crossing A.697 east of Thrunton to rejoin C.90 east of Whittingham Station.	Alnwick.	2.38	2.38
U.4003	Thrunton Mill Road.	From C.90 west of Mount Hooly to the Swine Burn at Thrunton Mill.	Alnwick.	0.36	0.36
U.4004	Thrunton Red House-Wandysteads.	From U.4002 south-west of Thrunton via Thrunton Red House and Coe Burn Bridge to A.697 north of Wandysteads.	Alnwick.	2.40	2.40
U.4005	High Trehitt-Lorbottle Road.	From C.176 at High Trehitt eastwards to C.178 at Lorbottle including the branch road to Lorbottle Weststeads.	Alnwick.	2.35	2.35
U.4006	Lorbottle-Mount Pleasant Road.	From C.178 south-west of Lorbottle Hall north-westwards to the Church at Mount Pleasant.	Alnwick.	0.67	0.67
U.4007	Yetlington North Road.	From C.174 at Yetlington northwards to C.172.	Alnwick.	0.37	0.37
U.4008	Callaly-Eslington Lowhill Road.	From C.174 west of Callaly North Lodge to C.172 at Eslington Lowhill.	Alnwick.	1.29	1.29
U.4009	Urchin Bank-Eslington Hall Road.	From C.172 north-east of Urchin Bank via Little Ryle and Eslington Hall to C.172 east of Eslington Lowhill.	Alnwick.	3.03	3.03
U.4010	Eslington Hall West Lodge-Mere Burn Road.	From C.172 at Eslington High Hill via Eslington Hall West Lodge to C.169 at its crossing of the Mere Burn.	Alnwick.	0.88	0.88
U.4011	Great Ryle-Aln Fordway Road.	From C.169 at Great Ryle southwards to U.4009 at the River Aln Fordway north of Little Ryle.	Alnwick.	0.75	0.75
U.4012	Alnham-Little Ryle Road.	From C.169 north-east of Alnham eastwards to U.4009 south of Little Ryle.	Alnwick.	1.48	1.48



# Extract from the Council's 1964 Highways Map

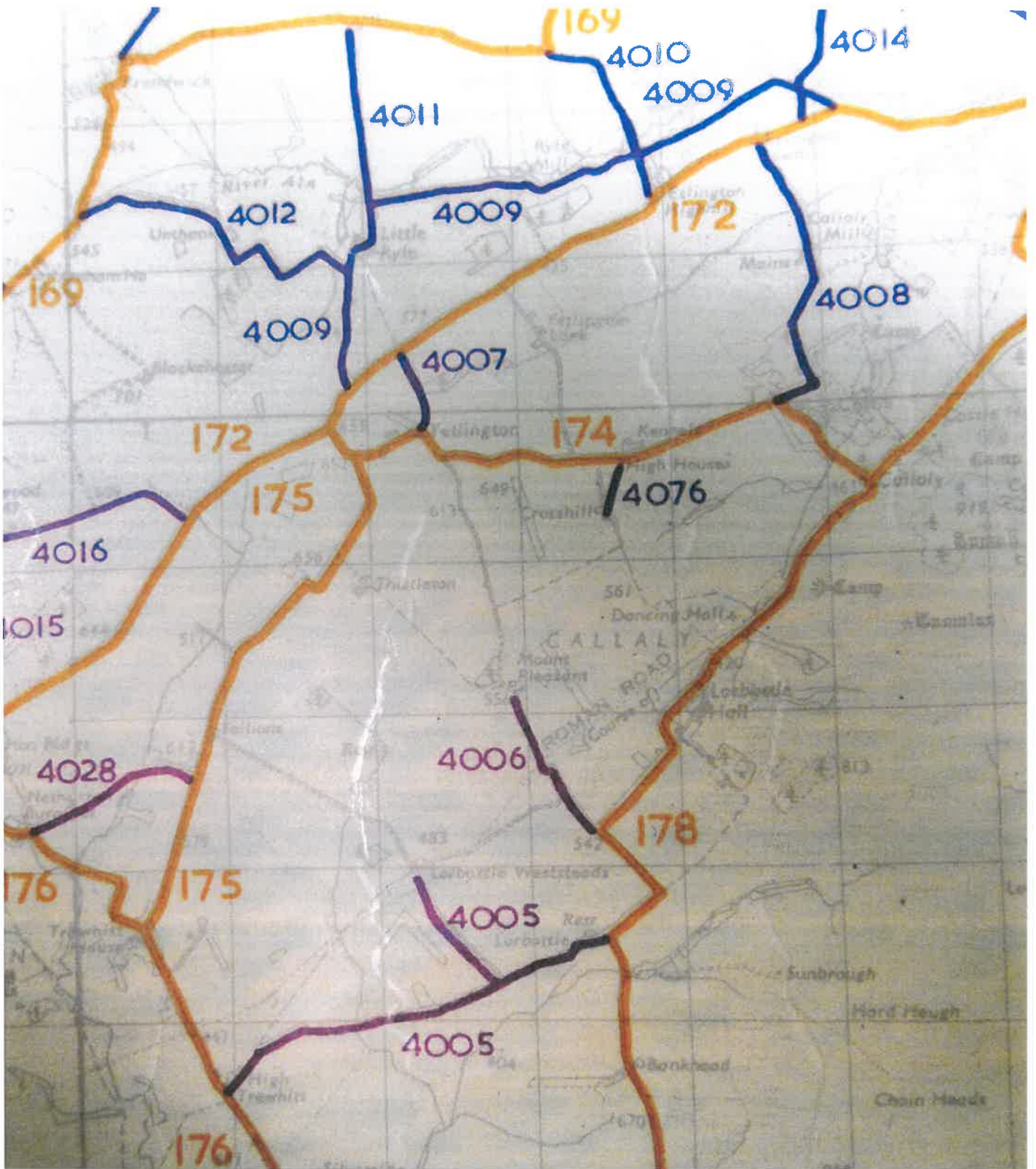

# 1974 County Road Schedule

Route No.	Name of Road	Description	Responsible Division or Authority	Mileage	Total Mileage
J.4004	Thrunton Red House-Wandysteads.	From U.4002 south-west of Thrunton (NU 084104) southwards via Thrunton Red House and Coe Burn Bridge to A.697 north of Wandysteads (NU 093069).	Alnwick Division		2.40
J.4005	High Trewitt-Lorbottle Road.	From C.176 at High Trewitt (NU 009055) eastwards to C.178 at Lorbottle (NU 035065) including the branch road to Lorbottle Weststeads,	Alnwick Division		2.35
J.4006	Lorbottle-Mount Pleasant Road.	From C.178 south-west of Lorbottle Hall (NU 034072) north-westwards to the Church at Mount Pleasant (NU 029081).	Alnwick Division		0.67
J.4007	Yetlington North Road.	From C.174 at Yetlington (NU 023099) northwards to C.172 (NU 022104).	Alnwick Division		0.37
J.4008	Callaly-Eslington Lowhill Road.	From C.174 west of Callaly North Lodge (NU 047100) northwards to C.172 at Eslington Lowhill (NU 046116).	Alnwick Division		1.29
J.4009	Urchin Bank-Eslington Hall Road.	From C.172 north-east of Urchin Bank (NU 019102) northwards and eastwards via Little Ryle and Eslington Hall to C.172 east of Eslington Lowhill (NU 051119).	Alnwick Division		3.03
J.4010	Eslington Hall West Lodge-Mere Burn Road.	From C.172 at Eslington High Hill (NU 039114) northwards via Eslington Hall West Lodge to C.169 at its crossing of the Mere Burn (NU 033124).	Alnwick Division		0.88
J.4011	Great Ryle-Aln Fordway Road.	From C.169 at Great Ryle (NU 020127) southwards to U.4009 at the River Aln Fordway north of Little Ryle. (NU 020114).	Alnwick Division		0.75
J.4012	Alnham-Little Ryle Road.	From C.169 north-east of Alnham (NU 001114) eastwards to U.4009 south of Little Ryle (NU 019110).	Alnwick Division		1.48

Extract from an undated 1:10,560 scale Council Highways Map

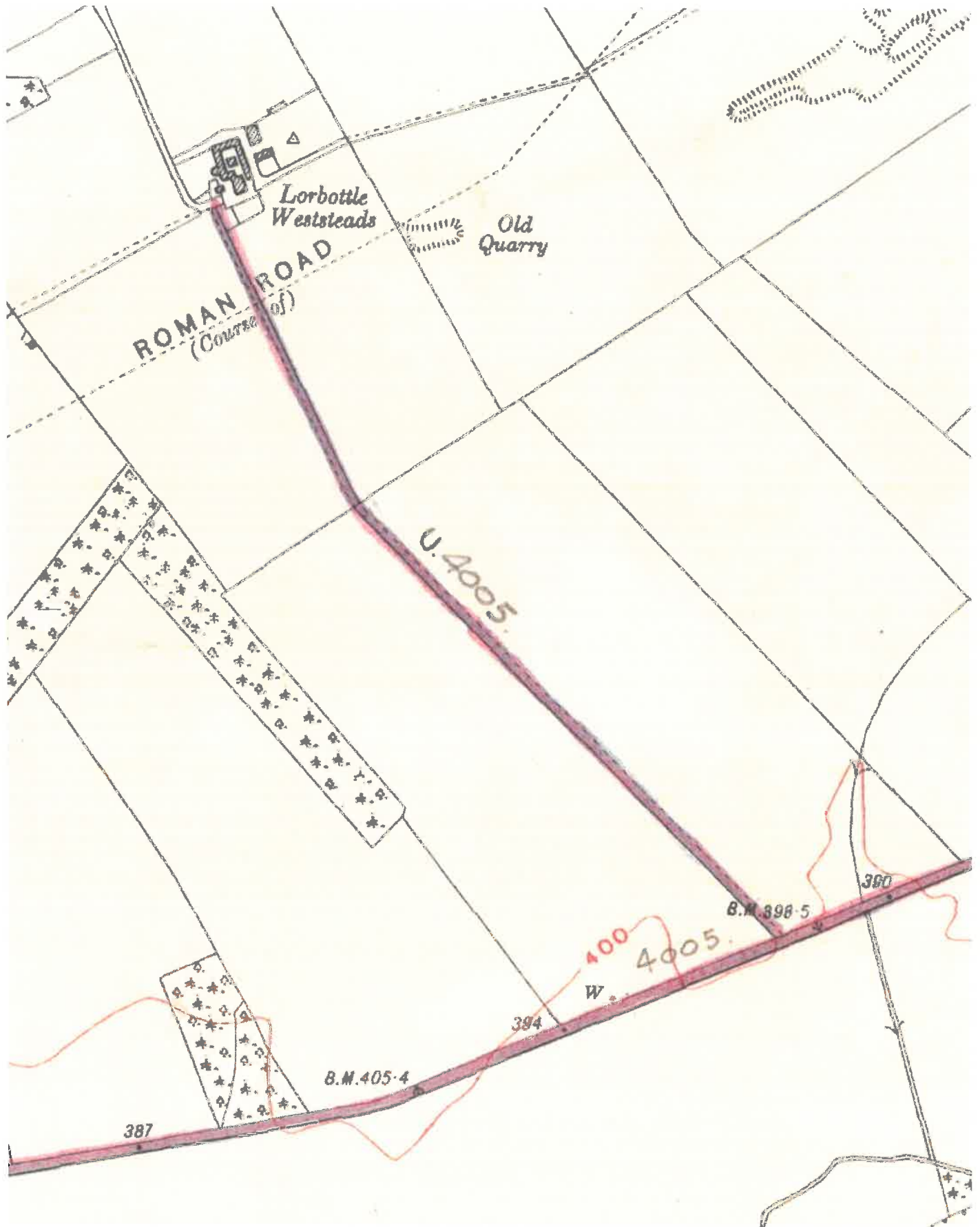

Extract from an undated 1:2500 scale Council Highways Map

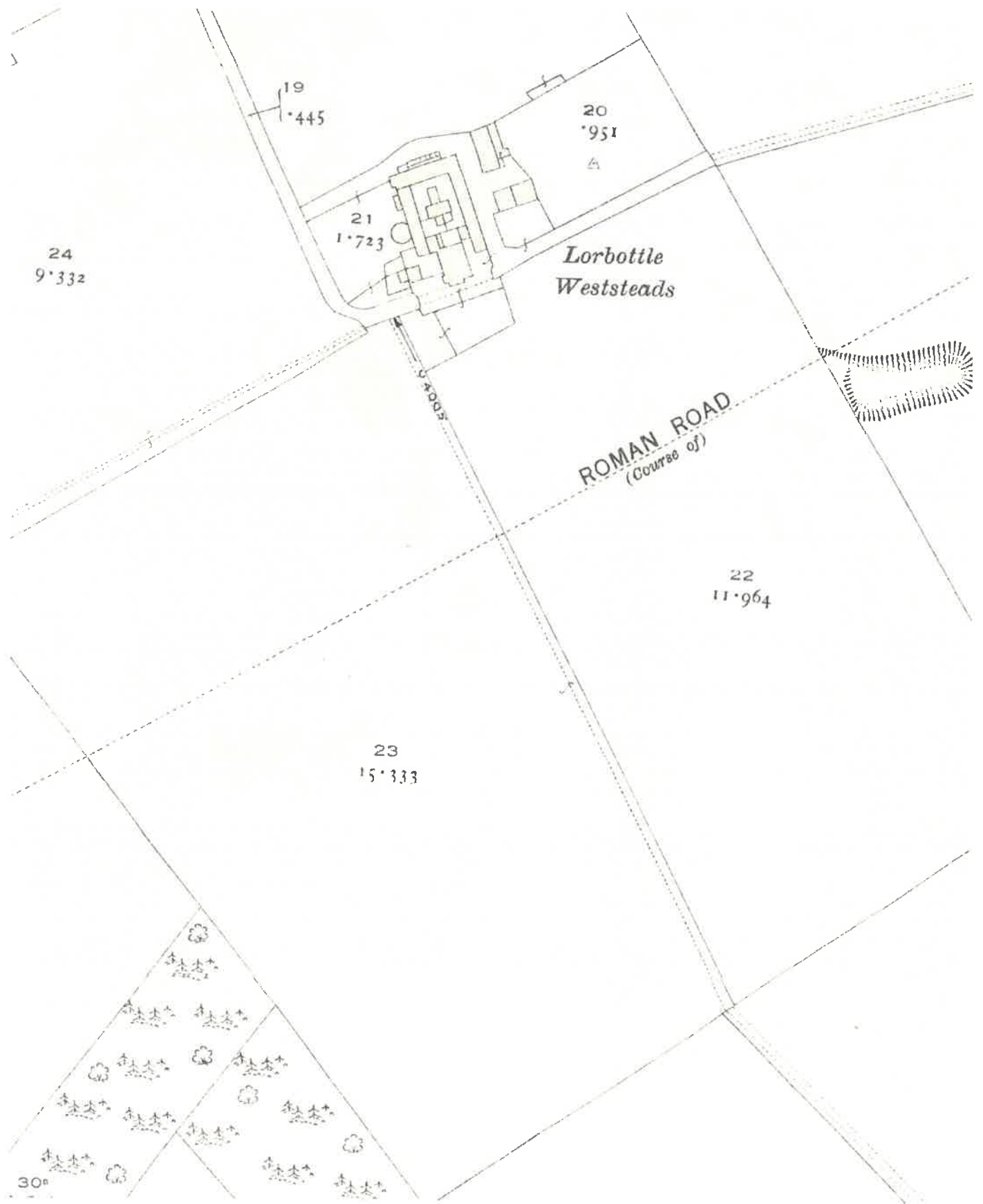



1:10,000 O.S. Map  
1979

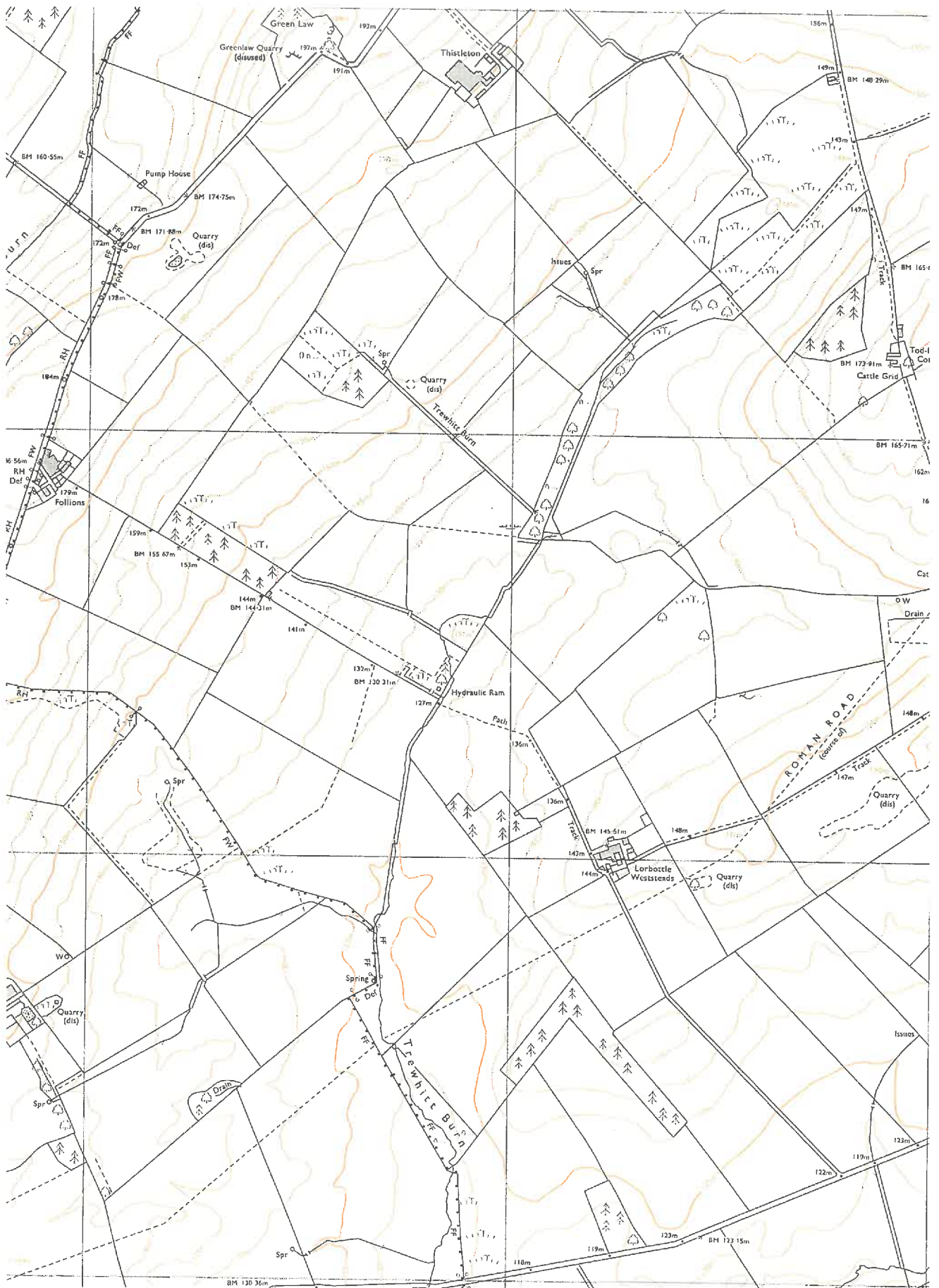



# Ordnance Survey Explorer Map 332

1:25,000  
(2005)

610  
23'  
609  
22'  
608  
21'  
607  
606  
605  
20'  
604  
NORTH EAST EURO ER  
SNITTER CP

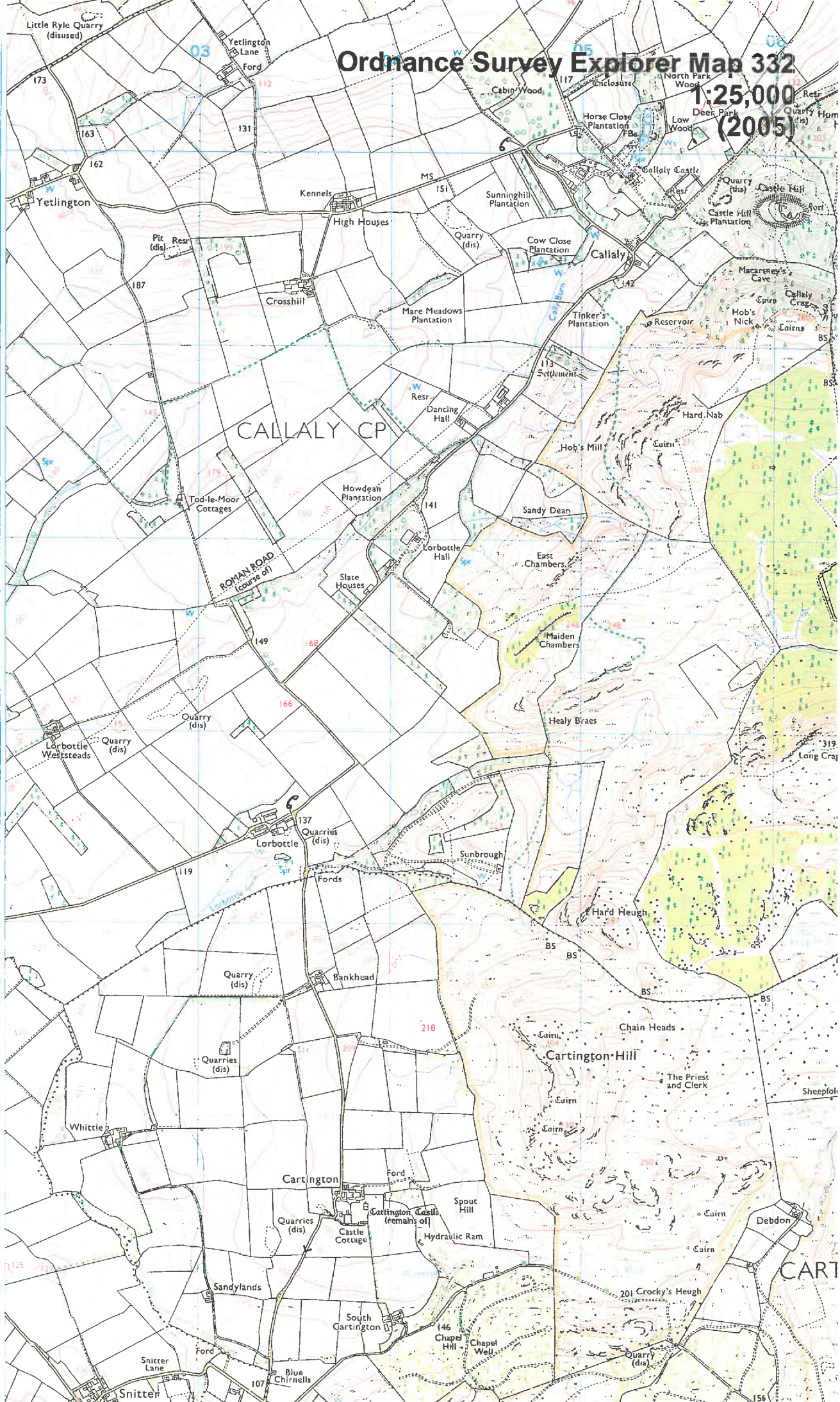

**Highways Act 1980 Section 36(6)**  
**County Of Northumberland**  
**List of Streets which are highways maintainable at the public expense**  
**As at 02-May-2006**

<b>Road Number</b>	<b>Description</b>	<b>Length - Metres</b>
<b>U40</b>		
	<i>Total length for U40</i>	549
<b>U4000</b>		
	HARDEN VIEW	22
	HARDEN VIEW	92
	<i>Total length for U4000</i>	114
<b>U4001</b>		
	THE GRANGE	89
	<i>Total length for U4001</i>	89
<b>U4002</b>		
	C90 JCT TO U4004 JCT	1,534
	U4004 JCT TO A697 JCT	1,074
	A697 JCT TO C90 JCT	1,262
	<i>Total length for U4002</i>	3,871
<b>U4003</b>		
	C90 JCT TO THRUNTON MILL	577
	<i>Total length for U4003</i>	577
<b>U4004</b>		
	A697 JCT TO U4002 JCT	3,860
	<i>Total length for U4004</i>	3,860
<b>U4005</b>		
	U4005 JCT TO C178 JCT	807
	U4005 JCT TO LORBOTTLE STEADS FARM	941
	C176 JCT TO U4005 LORBOTTLE STEADS	2,079
	<i>Total length for U4005</i>	3,827
<b>U4006</b>		
	C178 TO MOUNT PLEASANT CATTLEGRID	1,101



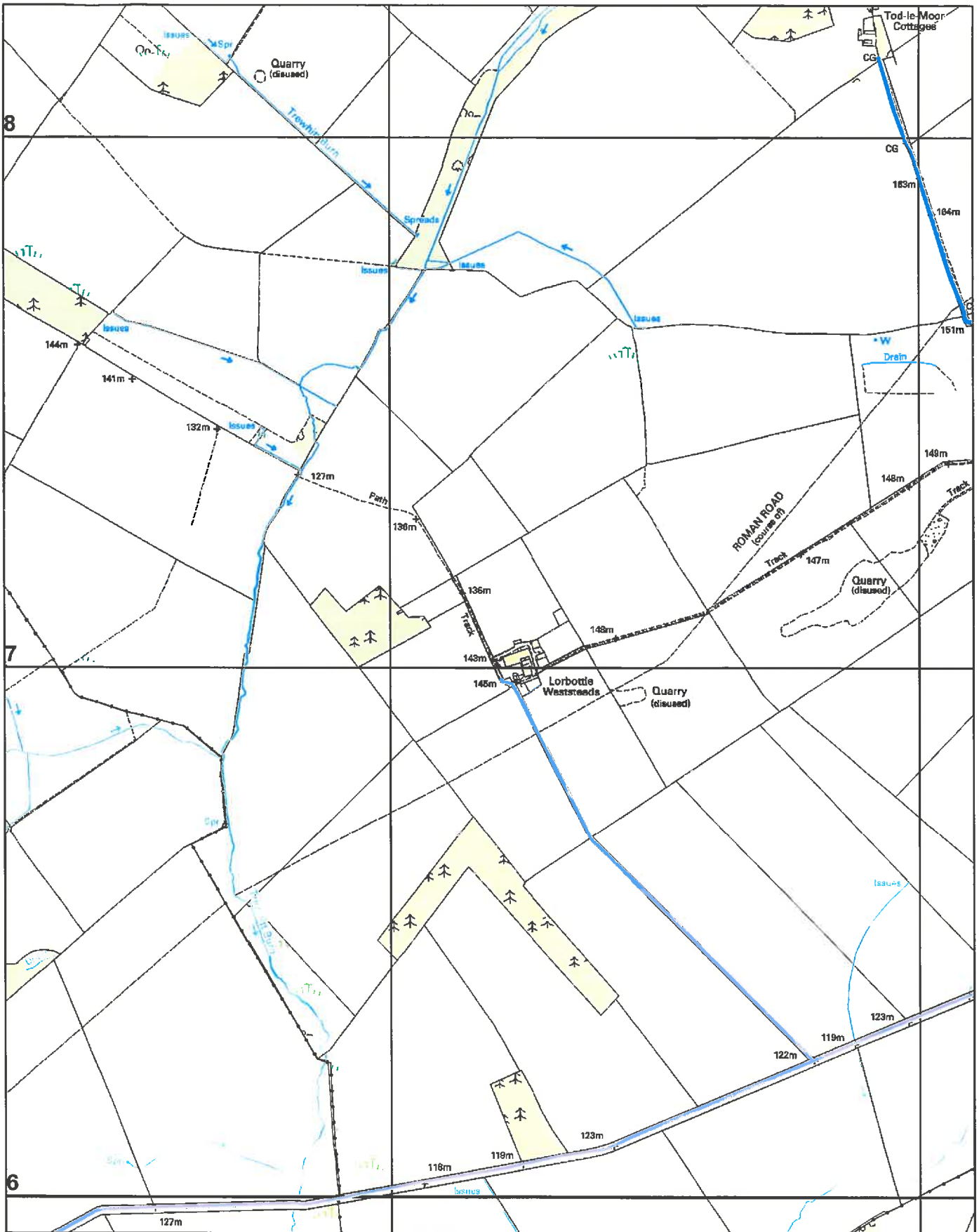

Network Management  
Information System

Highways Act 1980 Section 36(6)  
County of Northumberland  
List of Streets which are highways  
maintainable at the public expense  
as at 02-May-2006

This map is reproduced from Ordnance Survey material with the permission of Ordnance Survey on behalf of the Controller of Her Majesty's Stationary Office Crown Copyright. Unauthorised reproduction infringes Crown Copyright and may lead to prosecution or civil proceedings. License no. 100049048 (2015).

Drn:

Date:

Scale:

AB

Dec 2019

1:10,000